

*ICOS NG Pendant*

WHEN REPLACING PCB ASSEMBLIES, PLEASE WEAR AN ESD WRIST STRAP AND CONNECT IT TO ELECTRICAL GROUND

RISK OF FIRE AND ELECTRICAL SHOCK

Contact, improper installation, or improper servicing MAY RESULT IN DEATH OR SERIOUS INJURY! Fixture must be installed by a qualified electrician only. Fixture is intended for installation in accordance with the National Electrical Code, local and federal code specifications. Disconnect power at electrical panel before servicing. Retain these instructions for maintenance reference.

ADVERTENCIA: RIESGO DE INCENDIO O IMPACTO ELÉCTRICO

Conexión, instalación inapropiada o servicio incorrecto PUEDE CAUSAR MUERTE O HERIDAS GRAVES. La luminaria debe ser instalada únicamente por un eléctrico calificado. La luminaria debe instalarse de acuerdo al Norma eléctrica nacional, al igual que especificaciones locales y normas federales. Se debe desconectar la corriente eléctrica antes de realizar la mantención. Conservar estas instrucciones como referencia para futuras mantenciones.

ATTENTION: RISQUE D'INCENDIE ET D'ELECTROCUTION

Une installation, un entretien ou un contact physique non conforme pourraient mener à un DANGER DE MORT OU DE BLESSURE GRAVE! L'appareil doit être installé uniquement par un électricien professionnel qualifié. L'installation doit respecter le code électrique national de même que les lois locales et fédérales en vigueur. Veuillez fermer l'alimentation électrique au panneau principal avant tout entretien. Conservé ces instructions pour référence et tout entretien futur.

NOTE

National or municipal codes must be followed regarding fixture installation and set back of thermal insulating material from luminaire. As a guideline, any insulation material must be held away from the luminaire by minimum of 3". Fixtures are not designed for direct contact with thermal insulation.



Overview

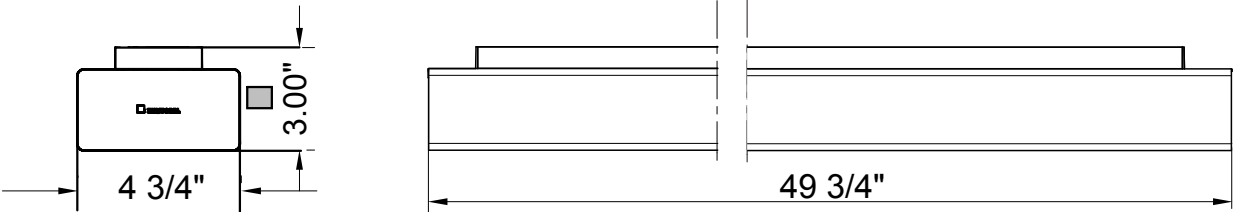

MOUNTING OPTIONS

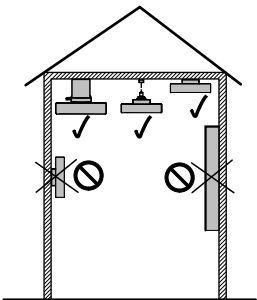

A
surface-
mounted

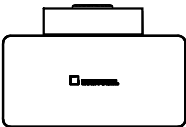

B
pendant

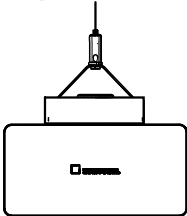

C
TECTON

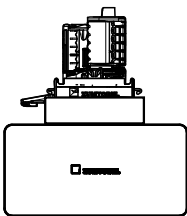

A **B**

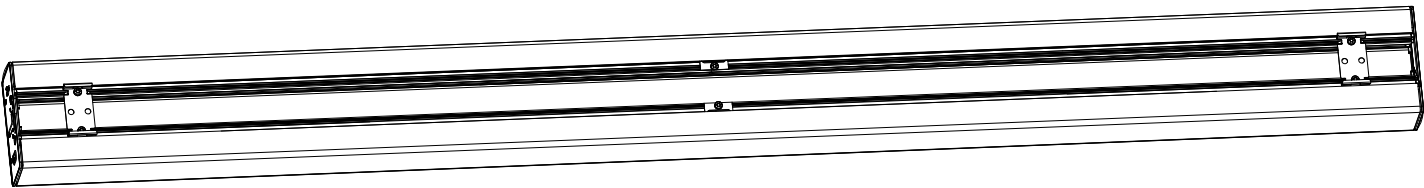
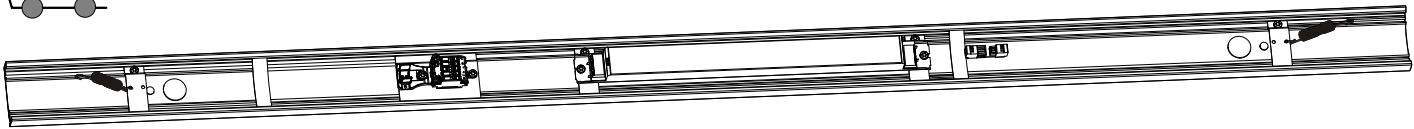

Backbone Prep - Pendant

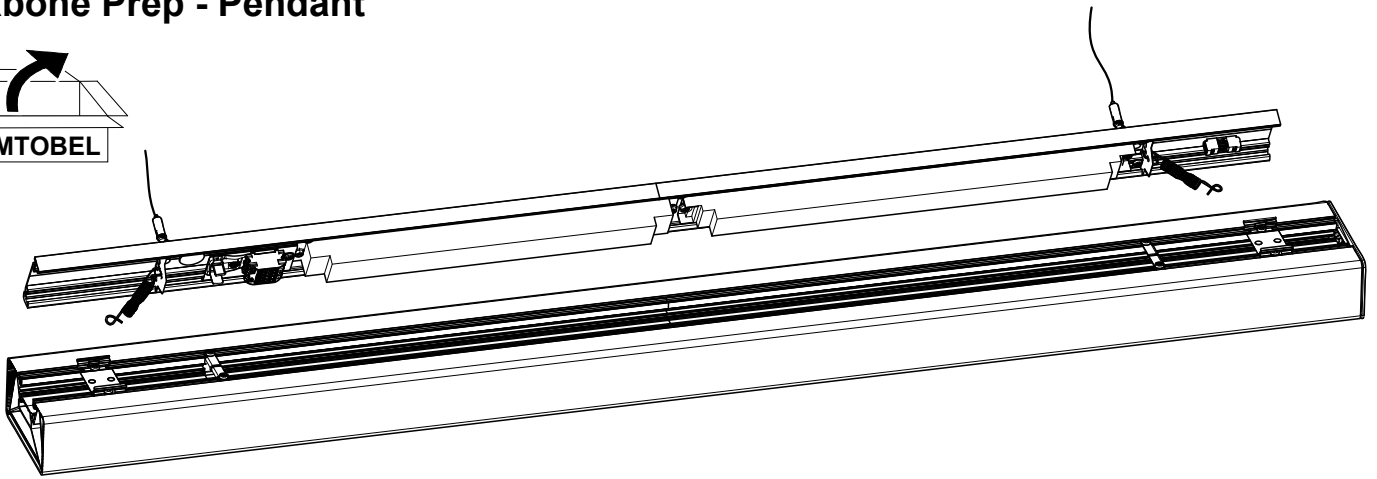

Junction Box supplied by others

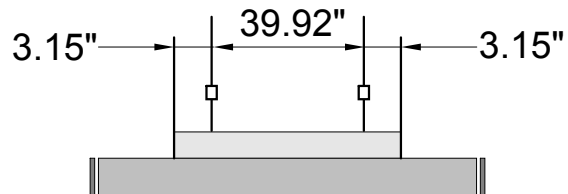
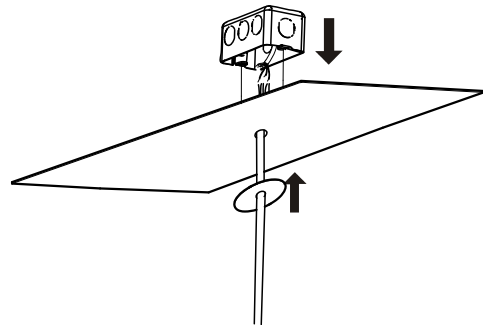

Only knock out on Feed Fixture

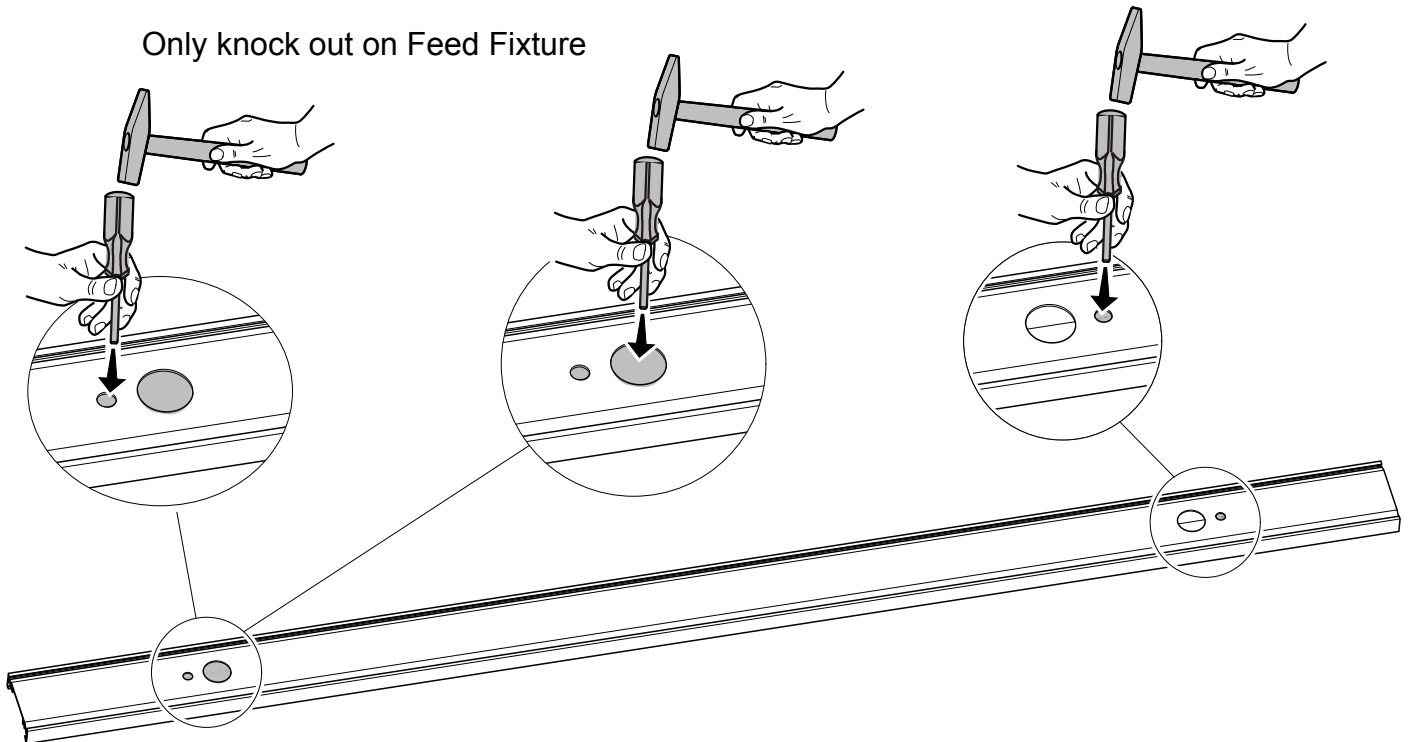

Backbone Install - Surface Mounting

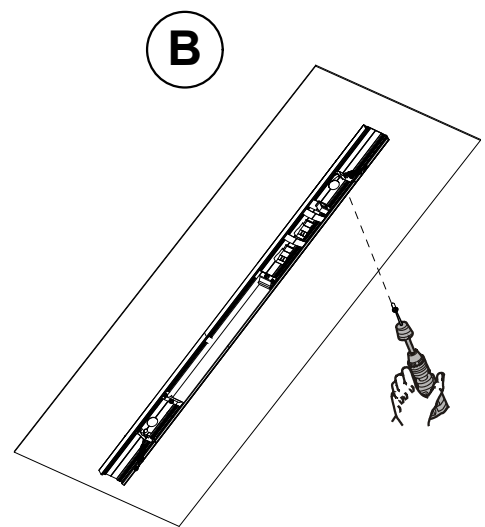
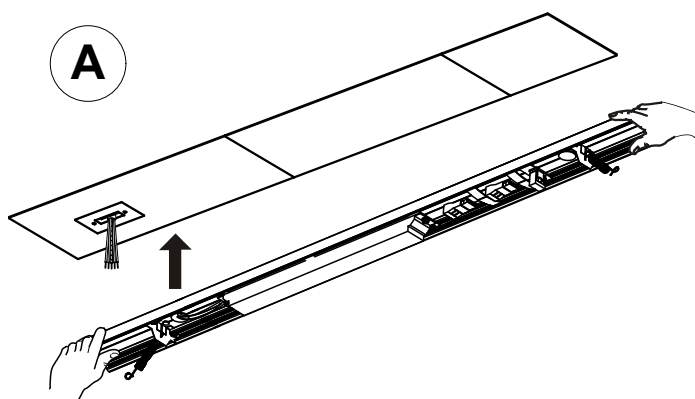
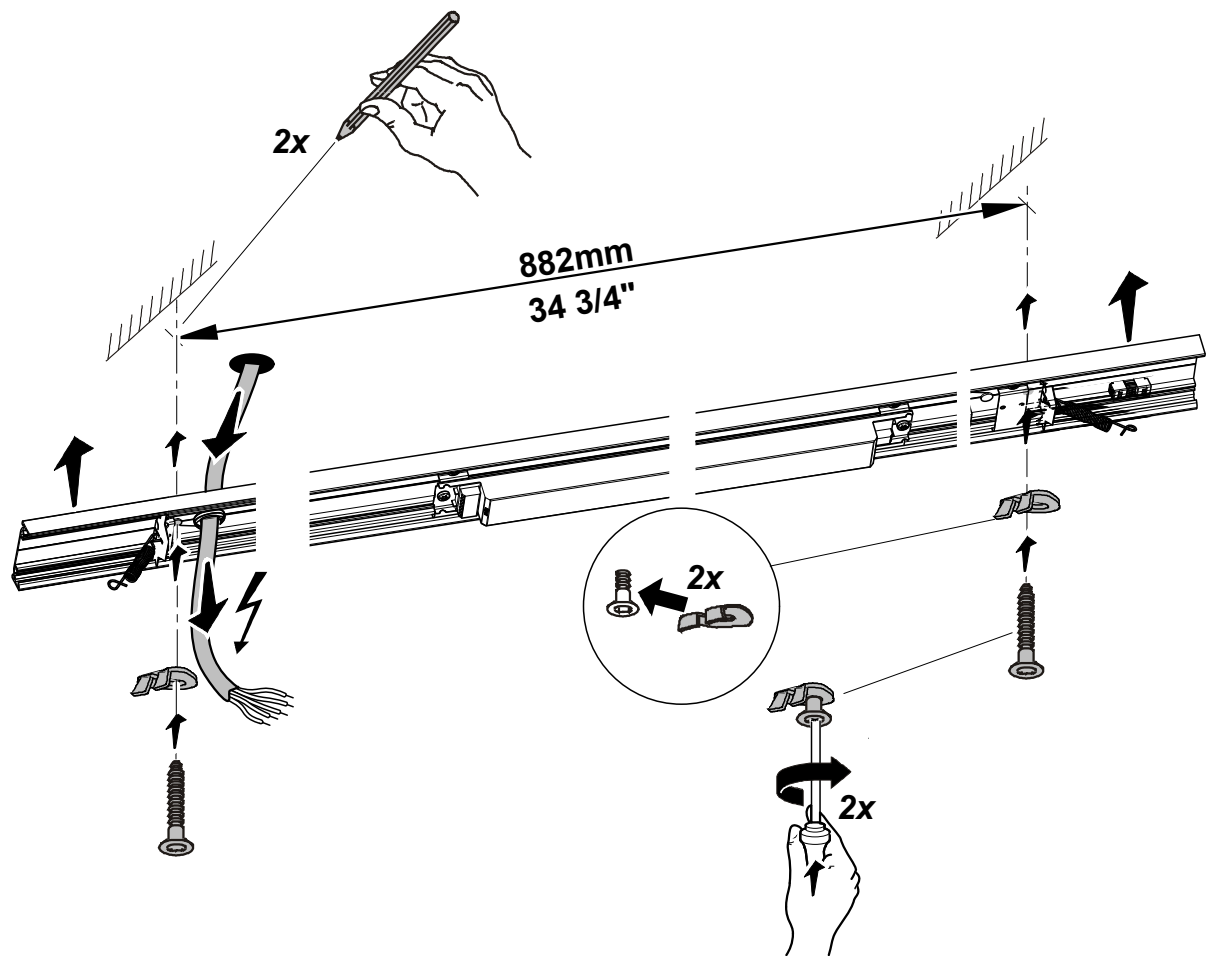

Must screw into Blocking

Backbone Install - Pendant Mount

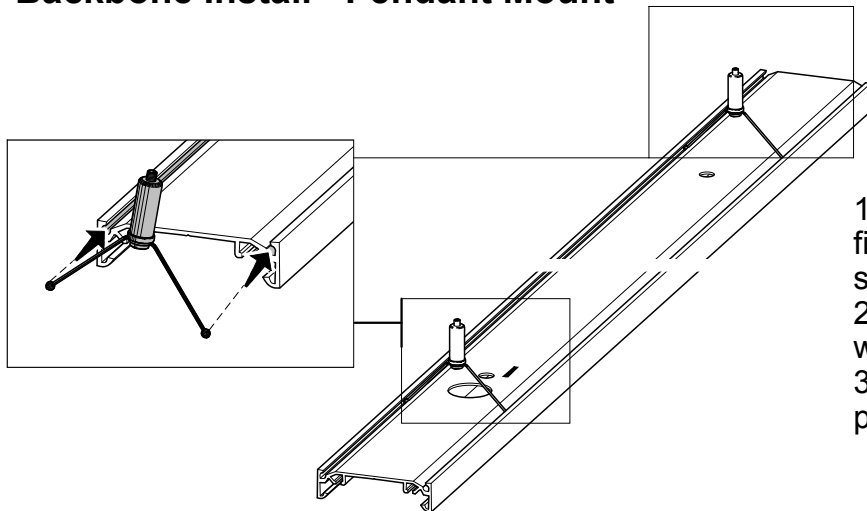

IMPORTANT:

1. When moving suspension cables along fixture, support fixture from underside so suspension moves freely in housing channel
2. Y-Cables should not be under load while sliding channel.
3. Suspension cables should be perpendicular to the housing.

Suspension Cables Spacing for Individual:

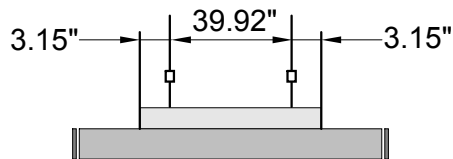

Suspension Cables Spacing for Countinuous run :

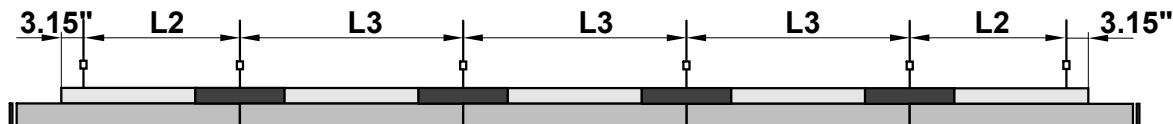

L2	L3
44.60"	49.25"

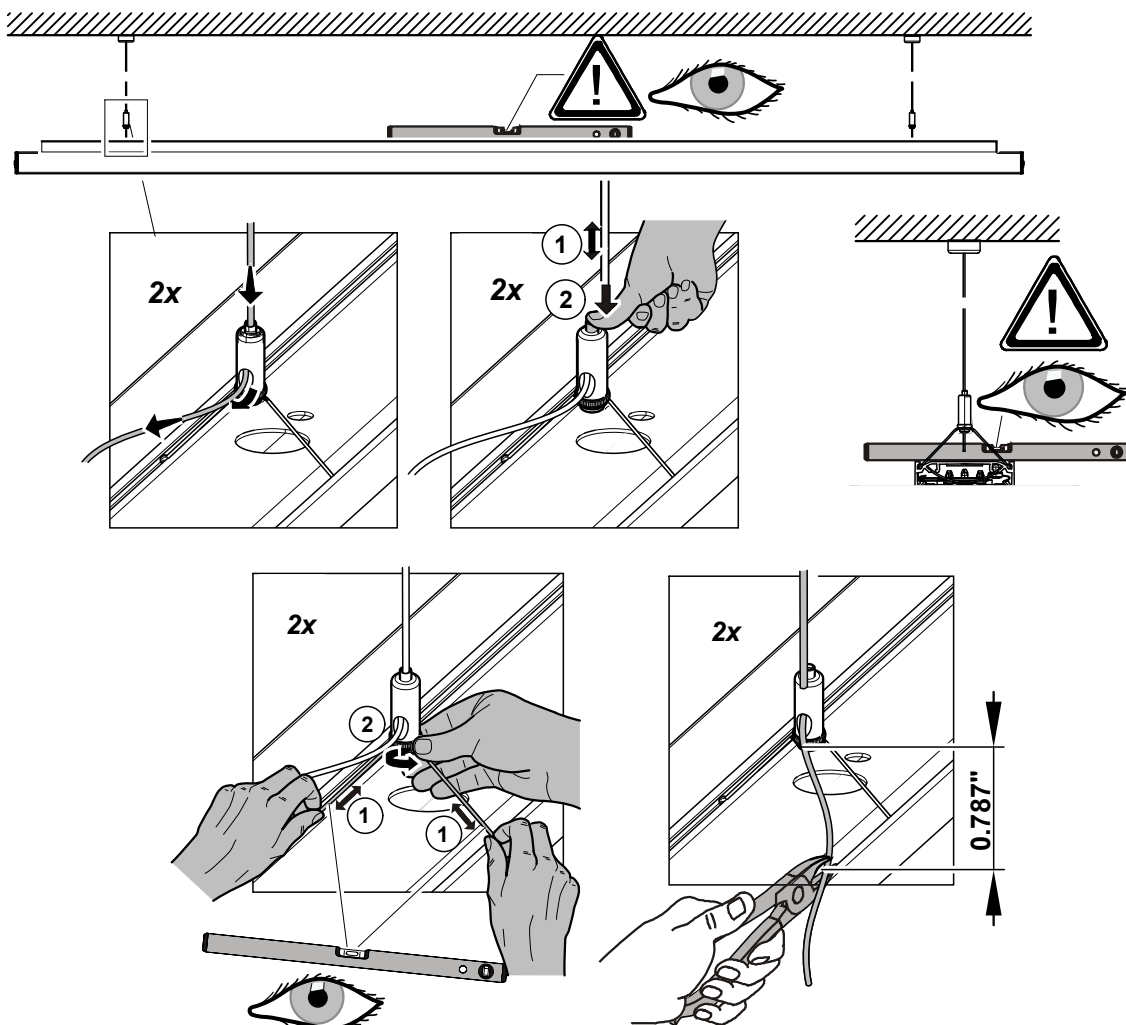

Feeding wiring

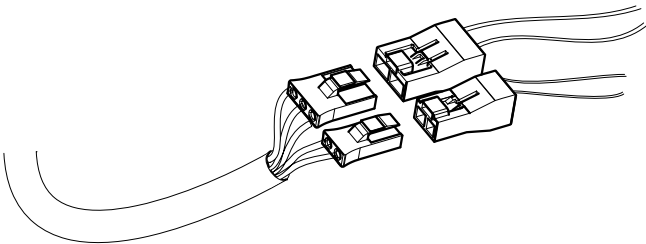
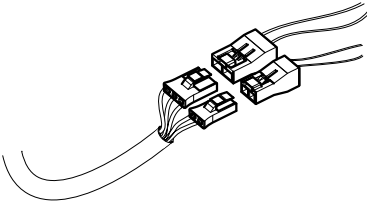
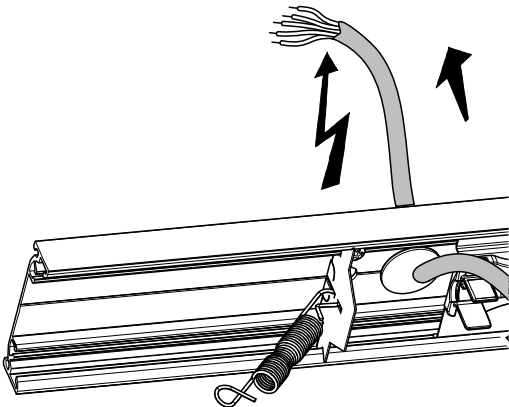

Color Codes	
Black	Load
White	Neutral
Green	Ground
Red	Switch Hot
Violet	Control +
Gray or Violet/Gray Strip	Control -

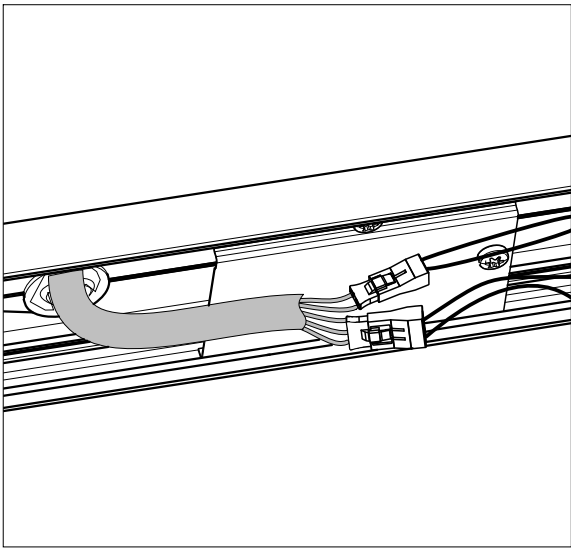

Continuous Row Joiner - Pendant and Surface Mount

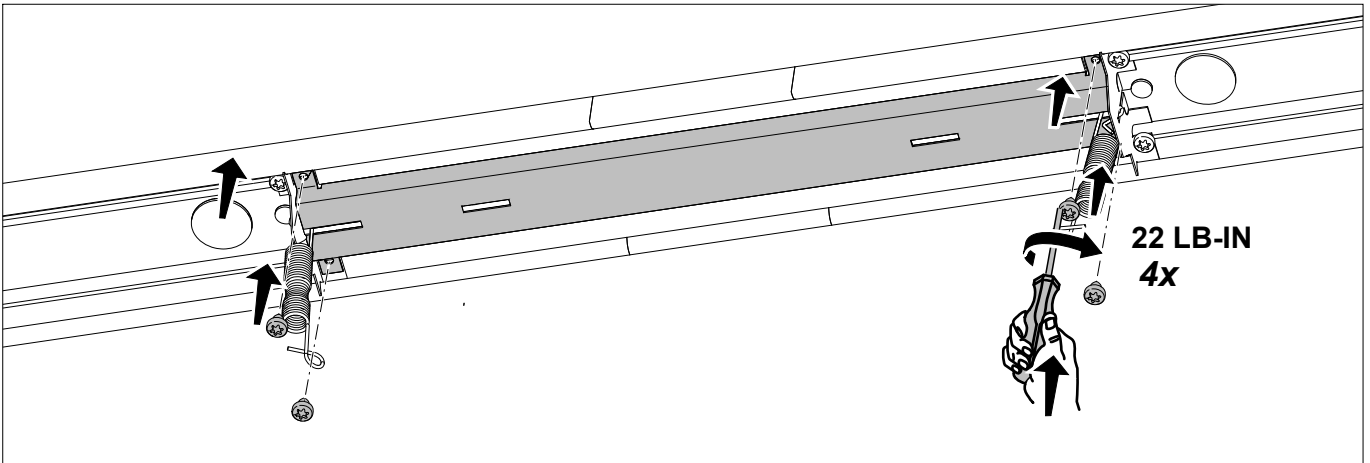
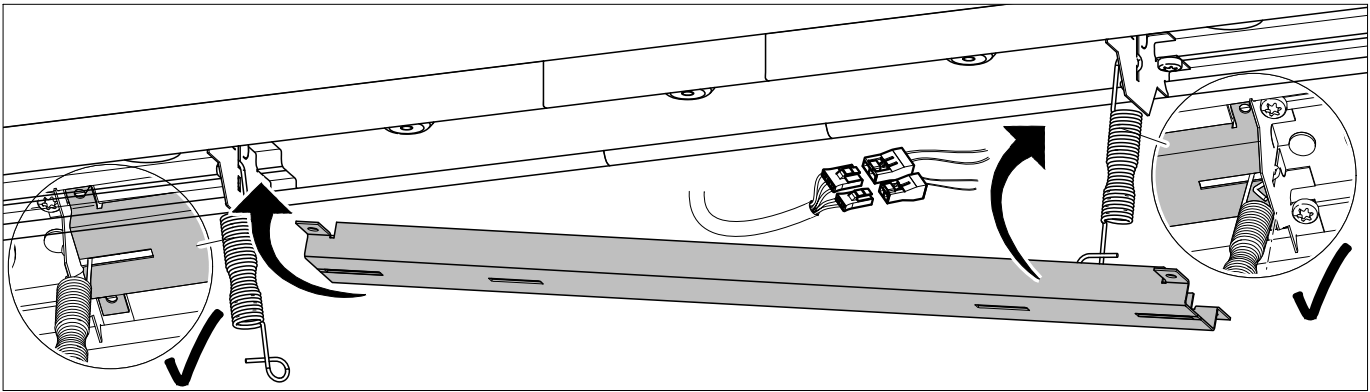
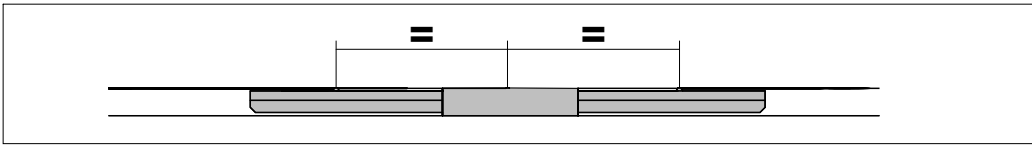
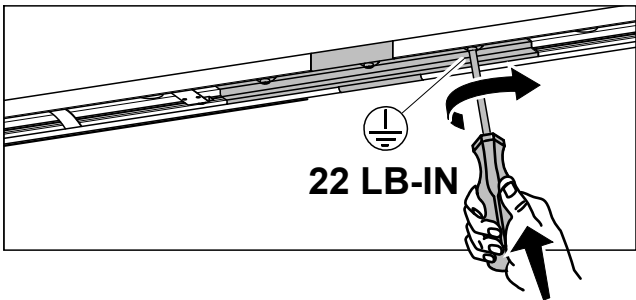
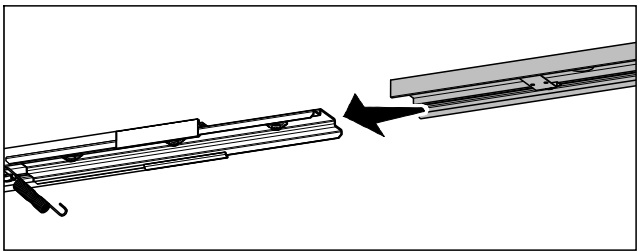
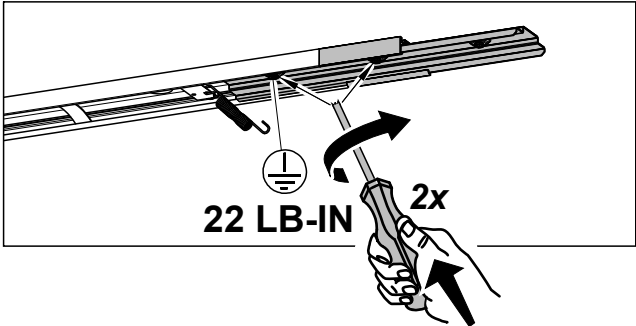
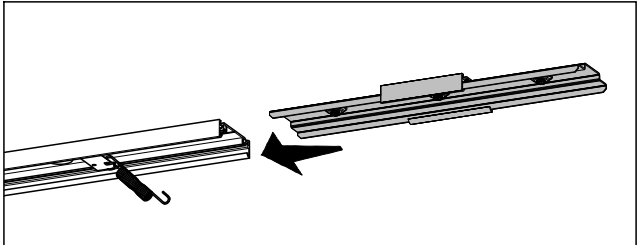
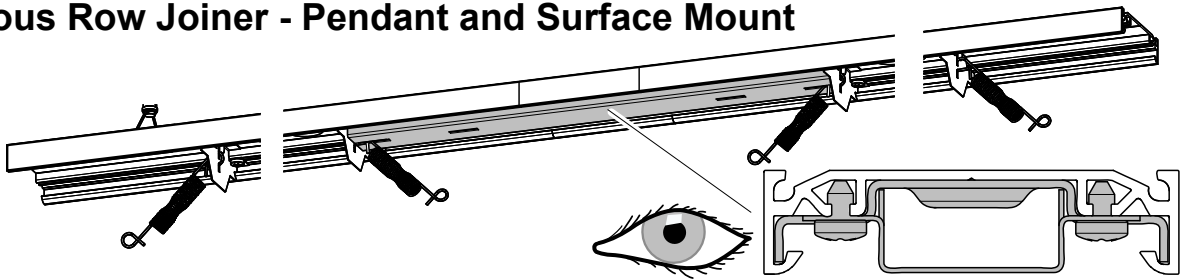

Light Engine Prep

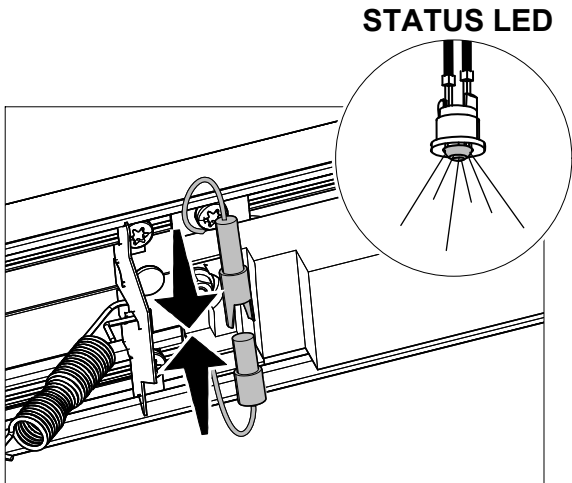
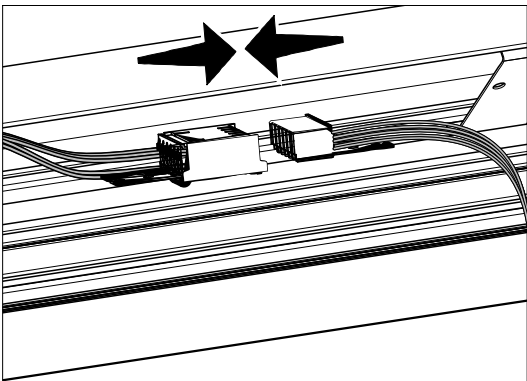
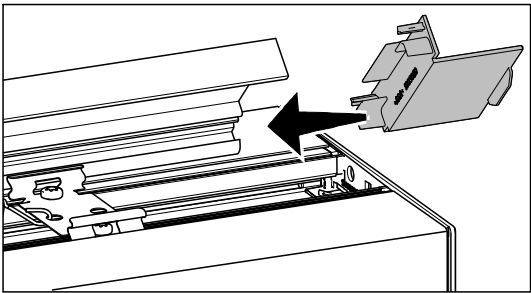
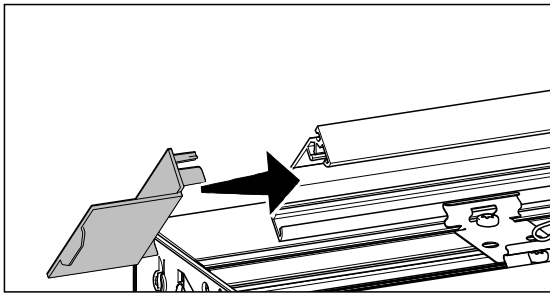
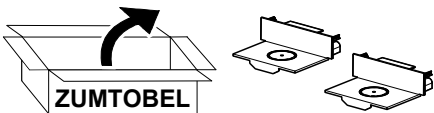
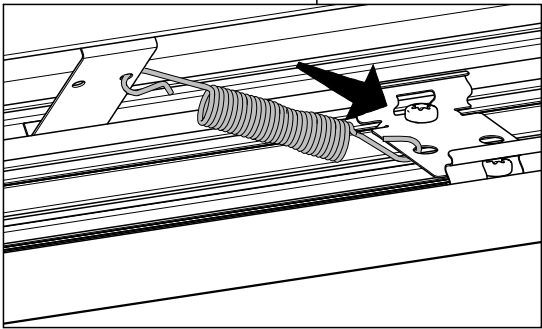
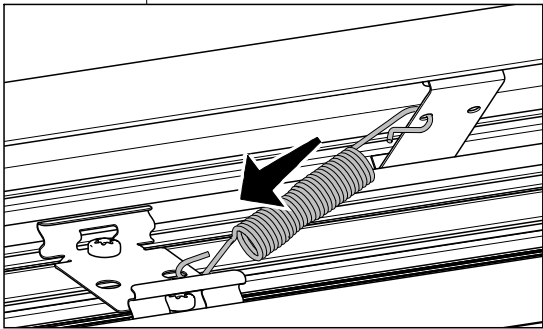
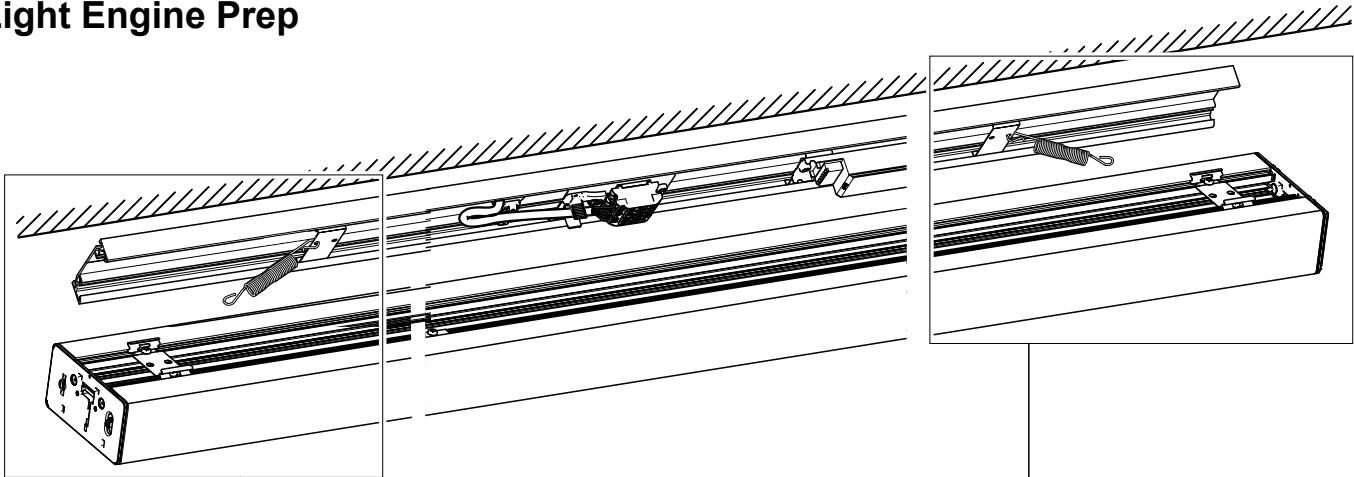

Light Engine Installation

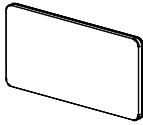
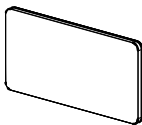
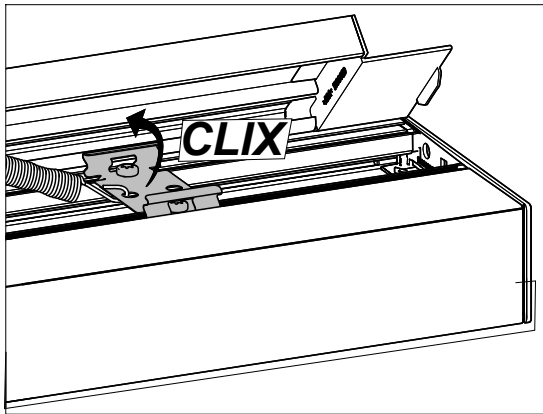
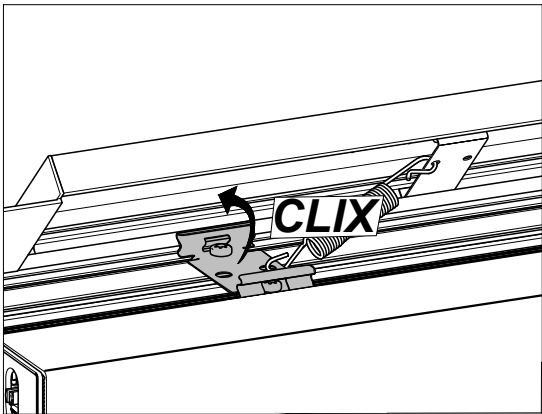

single luminaire

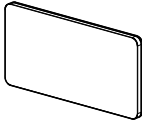
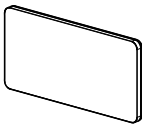
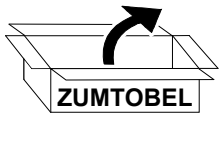
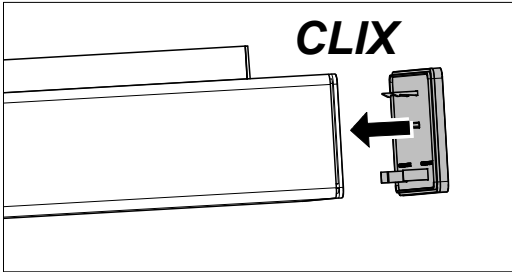
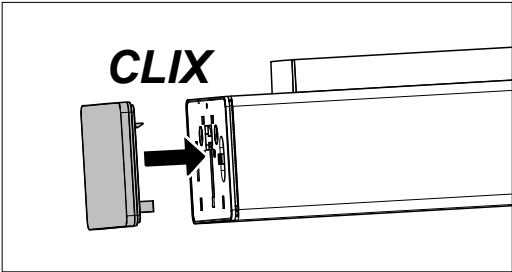

continuous row

