

# Installation Instructions

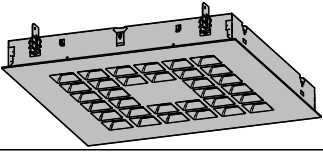

**Important Preinstallation Note:** These instructions are only for inaccessible ceilings (gypsum board or selected concealed). For other ceiling conditions, consult factory. Handle fixture carefully. Please refer to the approved layout drawings prior to installation, if applicable.

**MIREL LED 1'x4', 2'x2' RE  
Recessed Direct Fixture  
Individual**  
For Gypsum Board Ceilings Only

**DO NOT REMOVE THE LED ASSEMBLY. THIS WILL VOID THE WARRANTY. Call Zumtobel at 1-800-448-4131 for questions.**



## DANGER

### RISK OF FIRE AND ELECTRICAL SHOCK

Contact, improper installation, or improper servicing **MAY RESULT IN DEATH OR SERIOUS INJURY!** Fixture must be installed by a qualified electrician only. Fixture is intended for installation in accordance with the National Electrical Code, local and federal code specifications. Disconnect power at electrical panel before servicing. Retain these instructions for maintenance reference.



## READ ENTIRE INSTRUCTIONS BEFORE STARTING INSTALLATION

### 1 Unpack fixture.

Package contains the following parts:  
Single unit fixture. Ceiling Fixing Kit.

### 2 Remove luminaire from housing.

Use appropriate suction cups (made by Zumtobel).

### 1'x4' RE recessed

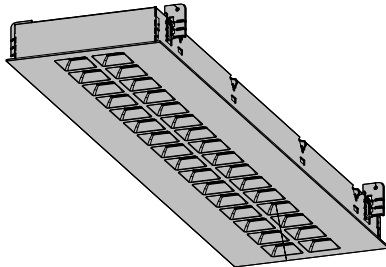

### 2'x2' RE recessed

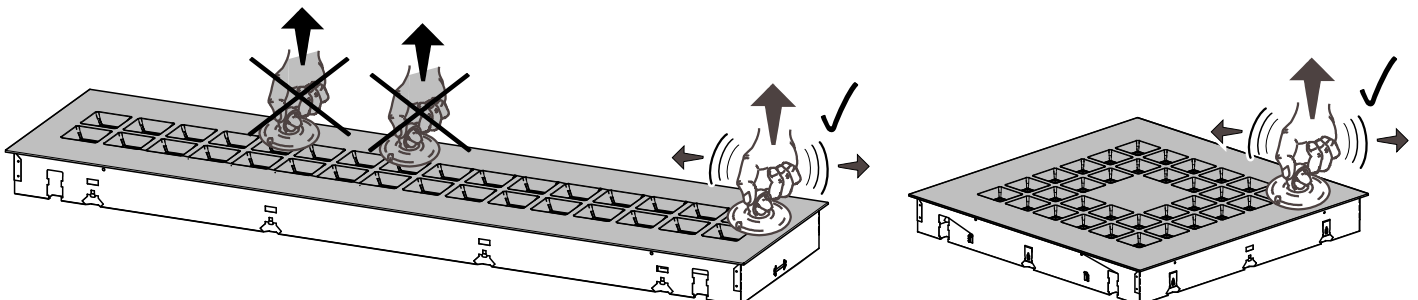
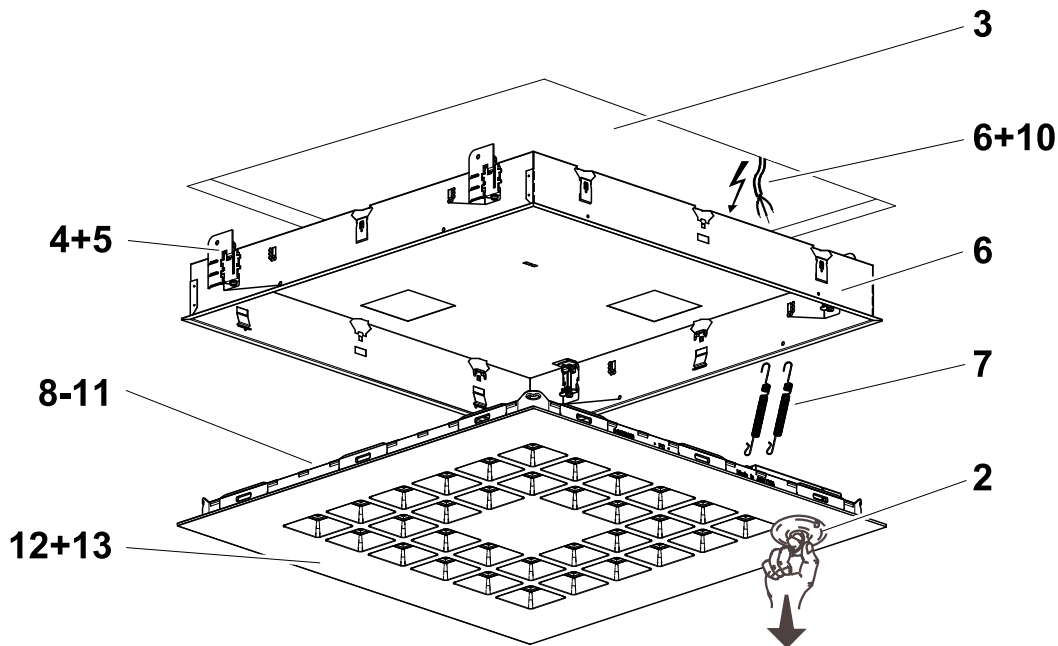
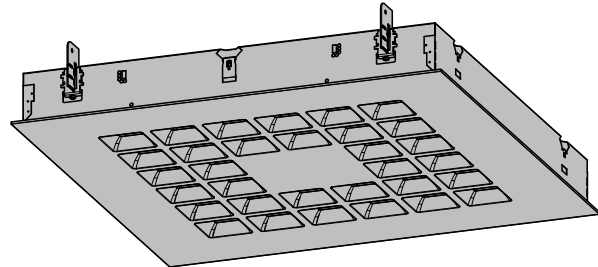

Installation Instructions

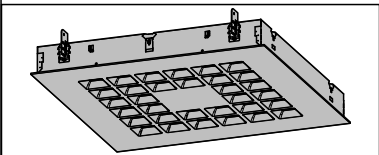

**Important Preinstallation Note:** These instructions are only for inaccessible ceilings (gypsum board or selected concealed). For other ceiling conditions, consult factory.  
Handle fixture carefully.  
Please refer to the approved layout drawings prior to installation, if applicable.

**MIREL LED 1'x4', 2'x2' RE  
Recessed Direct Fixture  
Individual**  
For Gypsum Board Ceilings Only

**DO NOT REMOVE THE LED ASSEMBLY. THIS WILL VOID THE WARRANTY. Call Zumtobel at 1-800-448-4131 for questions.**

**DANGER**

**RISK OF FIRE AND ELECTRICAL SHOCK**

Contact, improper installation, or improper servicing **MAY RESULT IN DEATH OR SERIOUS INJURY!**

Fixture must be installed by a qualified electrician only. Fixture is intended for installation in accordance with the National Electrical Code, local and federal code specifications. Disconnect power at electrical panel before servicing. Retain these instructions for maintenance reference.

**READ ENTIRE INSTRUCTIONS BEFORE STARTING INSTALLATION**

**3 Prepare ceiling.**  
Saw appropriate cutout into gypsum board ceiling. Refer to dimensions given in the tables.

**4 Chop fixing elements to desired height (4x).**  
Use pliers to break away one or two units.

**5 Mount fixing elements into housing (4x).**  
(Steps 5a - 5d)

	L	W	L <sub>C</sub>	W <sub>C</sub>	H	H <sub>max</sub>
1' x 4'	47.1	11.7	46.4	10.9	2.95	3.94

	L	W	L <sub>C</sub>	W <sub>C</sub>	H	H <sub>max</sub>
2' x 2'	23.5	23.5	22.7	22.7	2.95	3.94

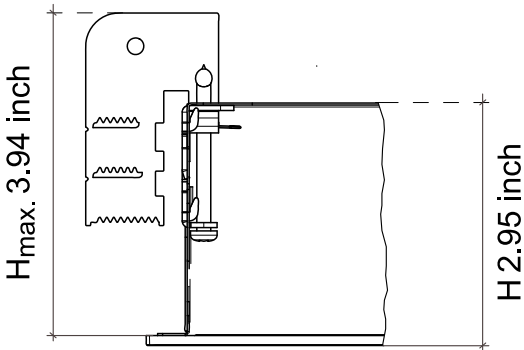

(L = Length, W = Width, L<sub>C</sub> = Length of cutout, W<sub>C</sub> = Width of cutout, H = Height of luminaire, H<sub>max</sub> = maximum Height needed for installation)

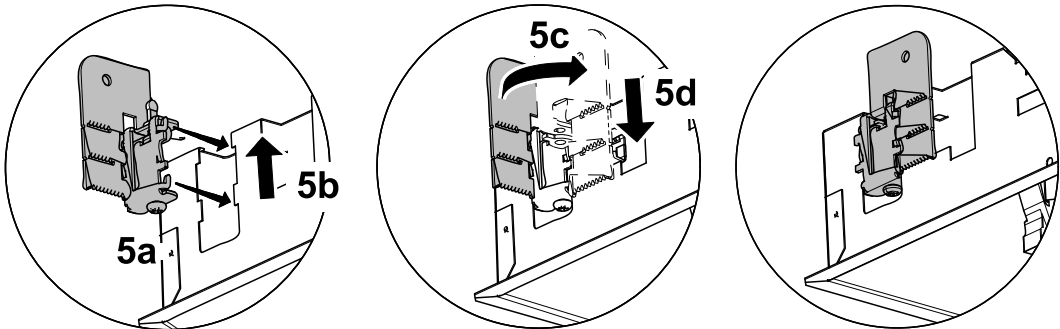
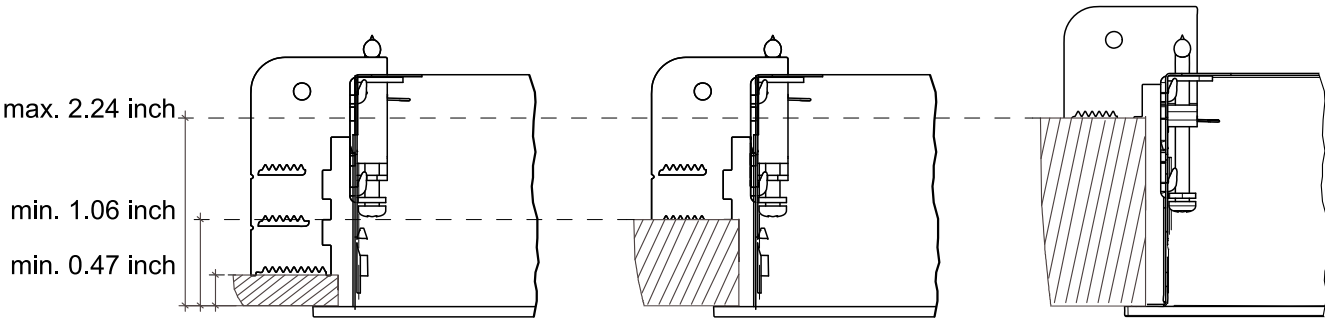

# Installation Instructions

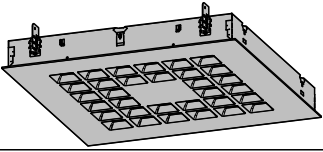

**Important Preinstallation Note:** These instructions are only for inaccessible ceilings (gypsum board or selected concealed). For other ceiling conditions, consult factory.  
Handle fixture carefully.  
Please refer to the approved layout drawings prior to installation, if applicable.

**MIREL LED 1'x4', 2'x2' RE  
Recessed Direct Fixture  
Individual**  
For Gypsum Board Ceilings Only

**DO NOT REMOVE THE LED ASSEMBLY. THIS WILL VOID THE WARRANTY. Call Zumtobel at 1-800-448-4131 for questions.**



## DANGER

### RISK OF FIRE AND ELECTRICAL SHOCK

Contact, improper installation, or improper servicing **MAY RESULT IN DEATH OR SERIOUS INJURY!**  
Fixture must be installed by a qualified electrician only. Fixture is intended for installation in accordance with the National Electrical Code, local and federal code specifications. Disconnect power at electrical panel before servicing. Retain these instructions for maintenance reference.



## READ ENTIRE INSTRUCTIONS BEFORE STARTING INSTALLATION

- 6 Pull cord through the opening of the housing.**  
6b) Install the housing into the opening of the ceiling.  
6c) Snap out the fixing elements (4x).  
6d) Tighten the screws. Pay attention to correct fixation.

- 7 Attach luminaire to the housing.**  
Use two safety springs (by Zumtobel) to hook in for further installation steps. Pay attention to correct fixation (7a - 7c).

**2'x2'**

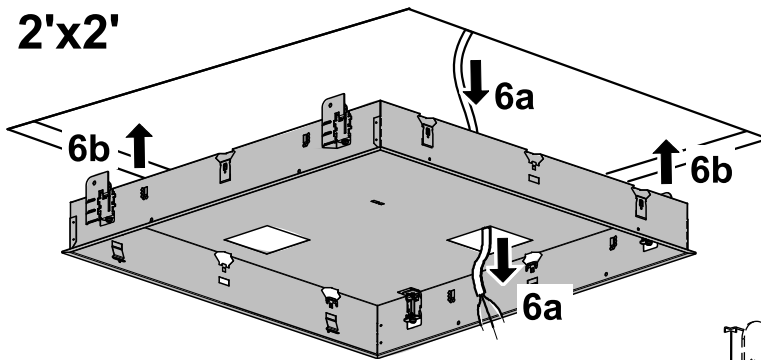

**1'x4'**

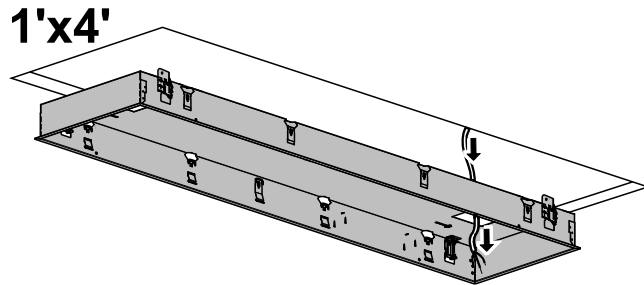

**6c**

**4x**

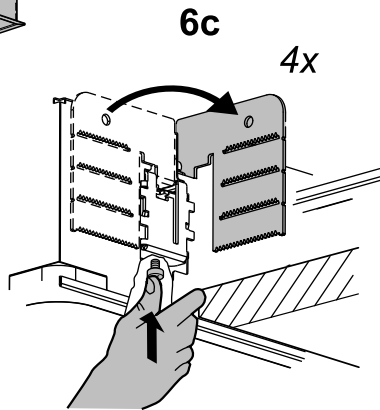

**6d**

**4x**

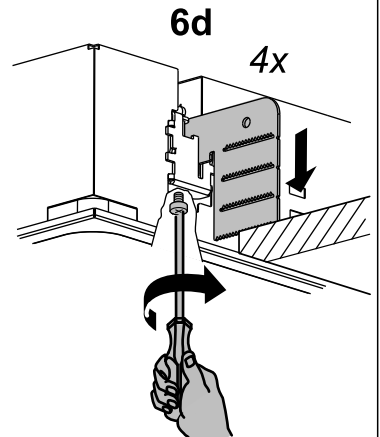

**2x**

**7a**

**7b**

**7c**

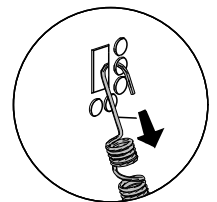
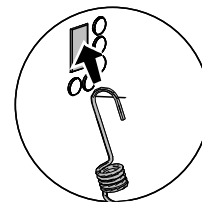
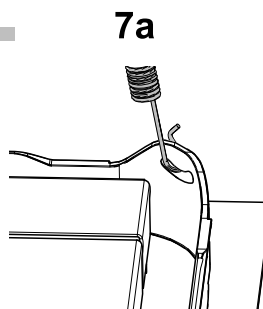
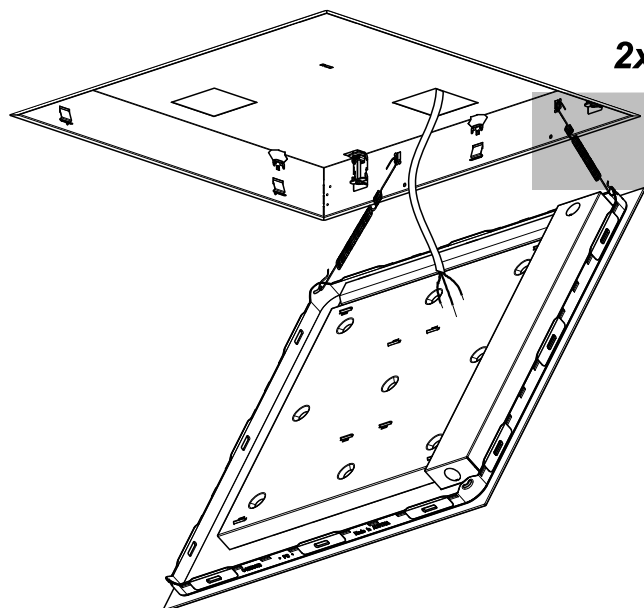

# Installation Instructions

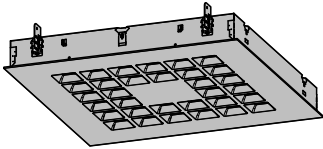

**Important Preinstallation Note:** These instructions are only for inaccessible ceilings (gypsum board or selected concealed). For other ceiling conditions, consult factory.  
Handle fixture carefully.  
Please refer to the approved layout drawings prior to installation, if applicable.

**MIREL LED 1'x4', 2'x2' RE  
Recessed Direct Fixture  
Individual**  
For Gypsum Board Ceilings Only

**DO NOT REMOVE THE LED ASSEMBLY. THIS WILL VOID THE WARRANTY. Call Zumtobel at 1-800-448-4131 for questions.**



## DANGER

### RISK OF FIRE AND ELECTRICAL SHOCK

Contact, improper installation, or improper servicing  
**MAY RESULT IN DEATH OR SERIOUS INJURY!**

Fixture must be installed by a qualified electrician only.  
Fixture is intended for installation in accordance with  
the National Electrical Code, local and federal code  
specifications. Disconnect power at electrical panel  
before servicing. Retain these instructions for  
maintenance reference.



## READ ENTIRE INSTRUCTIONS BEFORE STARTING INSTALLATION

### 8 Remove cover of the driver box.

Loosen two screws. Keep screws for remounting in step 11.

### 9 Break through knock-out opening 2.

Use a screw driver or any other appropriate tool to break through  
the cover of the driver box.

### 10 Trim power cord to the appropriate length.

Pull cord through knock-out opening 2 and make all  
electrical connections to the terminal block.

### 10a OPTION EMERGENCY LIGHTING

Connect battery pack connectors to activate emergency function.  
See manufacturers's leaflet for further instructions (by Iota).

### 11 Fix cover of the driver box again.

Use the screws which were removed in step 8.

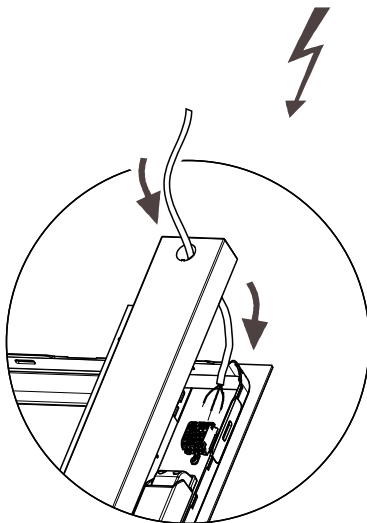
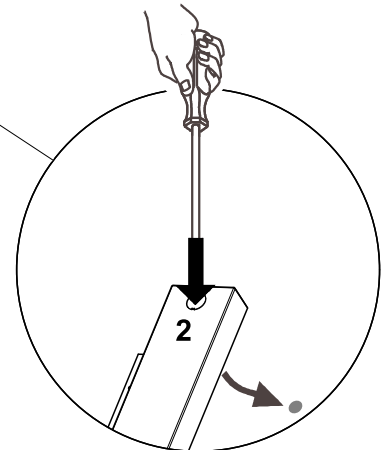
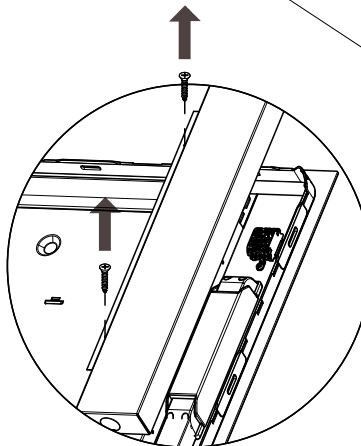
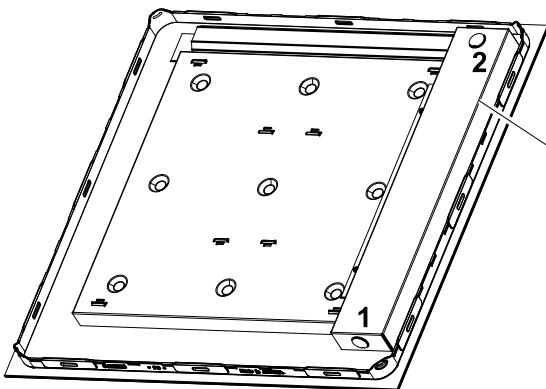

### OPTION EMERGENCY LIGHTING

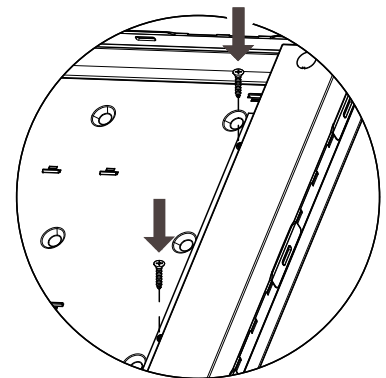
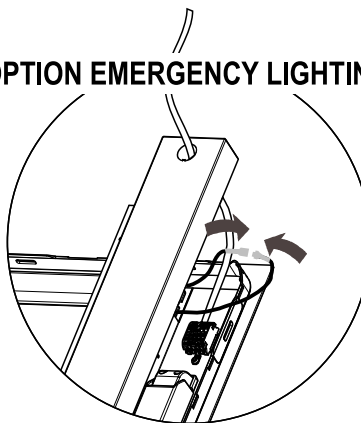



# Installation Instructions

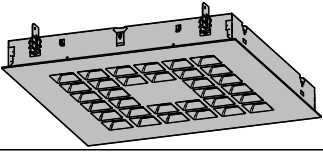

**Important Preinstallation Note:** These instructions are only for inaccessible ceilings (gypsum board or selected concealed). For other ceiling conditions, consult factory.  
Handle fixture carefully.  
Please refer to the approved layout drawings prior to installation, if applicable.

**MIREL LED 1'x4', 2'x2' RE  
Recessed Direct Fixture  
Individual**  
For Gypsum Board Ceilings Only

**DO NOT REMOVE THE LED ASSEMBLY. THIS WILL VOID THE WARRANTY. Call Zumtobel at 1-800-448-4131 for questions.**



## DANGER

### RISK OF FIRE AND ELECTRICAL SHOCK

Contact, improper installation, or improper servicing **MAY RESULT IN DEATH OR SERIOUS INJURY!**  
Fixture must be installed by a qualified electrician only. Fixture is intended for installation in accordance with the National Electrical Code, local and federal code specifications. Disconnect power at electrical panel before servicing. Retain these instructions for maintenance reference.



## READ ENTIRE INSTRUCTIONS BEFORE STARTING INSTALLATION

### 12 Close luminaire.

Snap luminaire into the housing (6x). Make sure power cord does not get caught between housing and luminaire. Pay attention that luminaire and housing tight fit into the ceiling.

### 13 Clean-up luminaire.

Use a soft fluffless cloth.

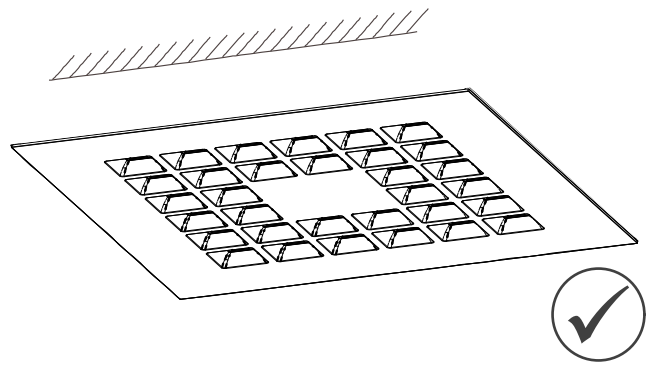
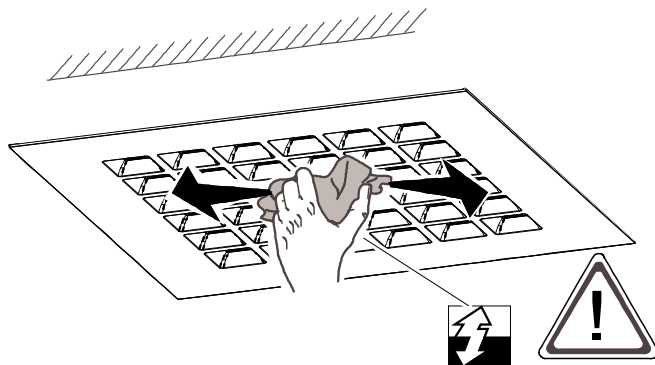
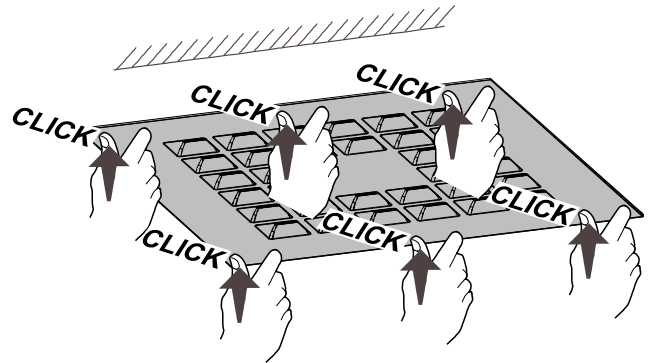
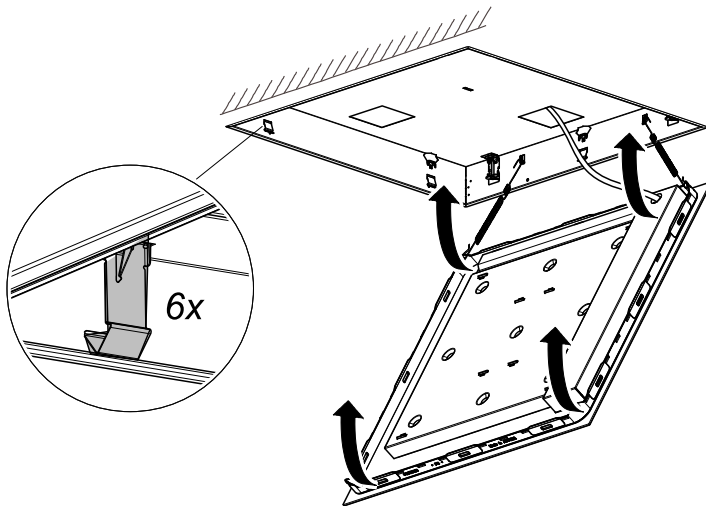

# Installation Instructions

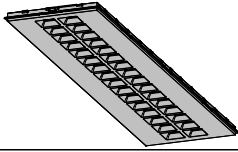

**Important Preinstallation Note:** These instructions are only for accessible ceilings (universal recessed flange or recessed flange flush mount). For other ceiling conditions, consult factory. Handle fixture carefully. Mounting to the ceiling can only be carried out by two persons. Please refer to the approved layout drawings prior to installation, if applicable.

**MIREL LED 1'x4', 2'x2' RU  
Recessed Direct Fixture  
Individual**  
For accessible Ceiling only

**DO NOT REMOVE THE LED ASSEMBLY. THIS WILL VOID THE WARRANTY. Call Zumtobel at 1-800-448-4131 for questions.**



## DANGER

### RISK OF FIRE AND ELECTRICAL SHOCK

Contact, improper installation, or improper servicing  
**MAY RESULT IN DEATH OR SERIOUS INJURY!**

Fixture must be installed by a qualified electrician only. Fixture is intended for installation in accordance with the National Electrical Code, local and federal code specifications. Disconnect power at electrical panel before servicing. Retain these instructions for maintenance reference.



## READ ENTIRE INSTRUCTIONS BEFORE STARTING INSTALLATION

### 1 Unpack fixture.

Package contains the following parts:

Single unit fixture. Set of adapters (8 pcs.) for flush mount.

**1'x4'  
recessed**

**2'x2'  
recessed**

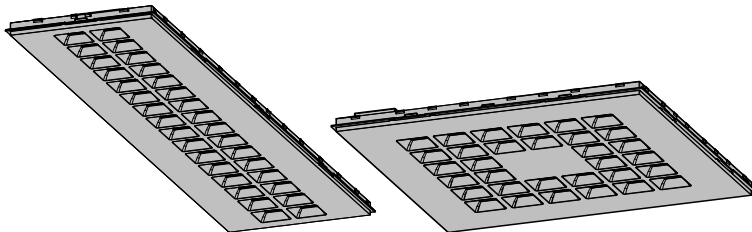

+  (8x)

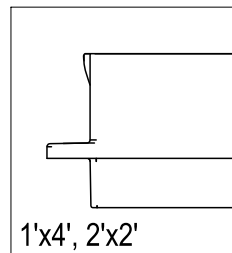

1'x4', 2'x2'

Universal recessed flange  
for 9/16" tegular mount

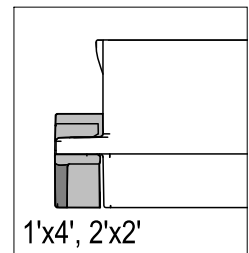

1'x4', 2'x2'

Recessed flange  
for 15/16" flush mount

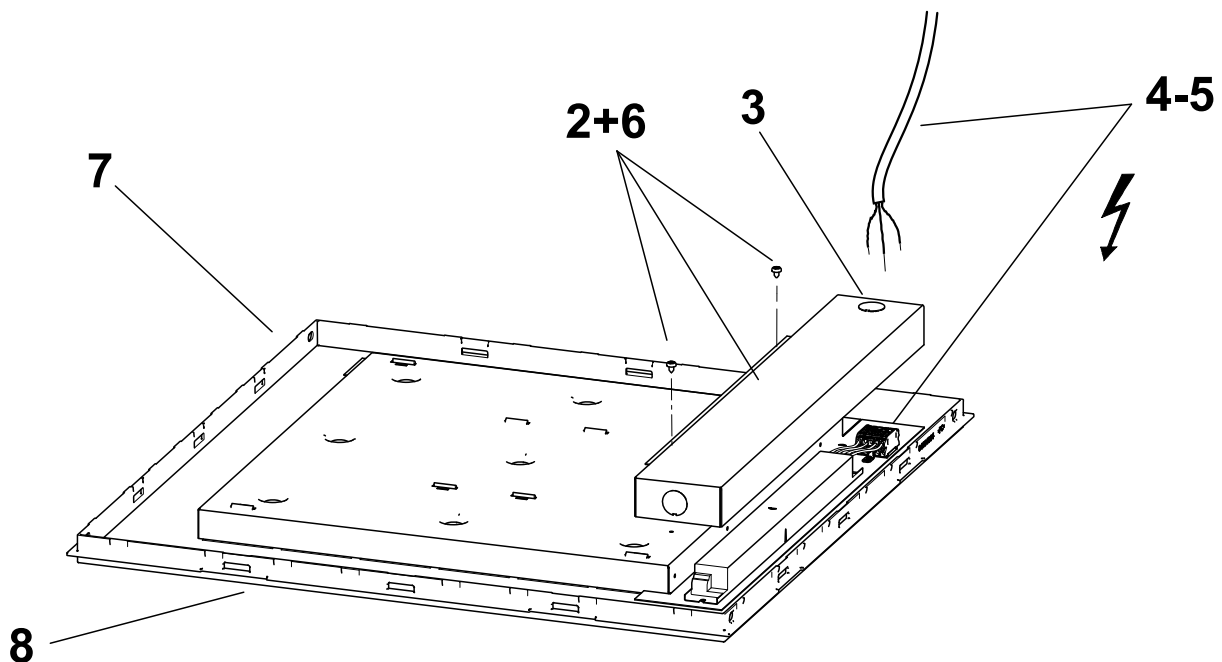

# Installation Instructions

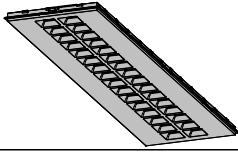

**Important Preinstallation Note:** These instructions are only for accessible ceilings (universal recessed flange or recessed flange flush mount). For other ceiling conditions, consult factory. Handle fixture carefully. Mounting to the ceiling can only be carried out by two persons. Please refer to the approved layout drawings prior to installation, if applicable.

**MIREL LED 1'x4', 2'x2' RU  
Recessed Direct Fixture  
Individual**  
For accessible Ceiling only

**DO NOT REMOVE THE LED ASSEMBLY. THIS WILL VOID THE WARRANTY. Call Zumtobel at 1-800-448-4131 for questions.**



## DANGER

### RISK OF FIRE AND ELECTRICAL SHOCK

Contact, improper installation, or improper servicing  
**MAY RESULT IN DEATH OR SERIOUS INJURY!**

Fixture must be installed by a qualified electrician only.  
Fixture is intended for installation in accordance with  
the National Electrical Code, local and federal code  
specifications. Disconnect power at electrical panel  
before servicing. Retain these instructions for  
maintenance reference.



## READ ENTIRE INSTRUCTIONS BEFORE STARTING INSTALLATION

### 2 Remove cover of the driver box.

Loosen two screws. Keep screws for remounting in step 6.

### 3 Break through knock-out opening 2.

Use a screw driver or any other appropriate tool to break through  
the cover of the driver box.

### 4 Trim power cord to the appropriate length.

Pull cord through knock-out opening 2.

### 5 Luminaire needs to be hold in place close to the ceiling.

A second person makes all electrical connections to the terminal block.

### 5a OPTION EMERGENCY LIGHTING

Connect battery pack connectors to activate emergency function.  
See manufacturers's leaflet for further instructions (by Iota).

### 6 Fix cover of the driver box again.

Use the screws which were removed in step 2.

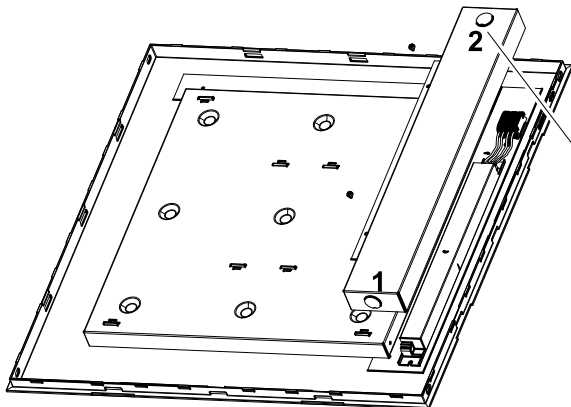

2

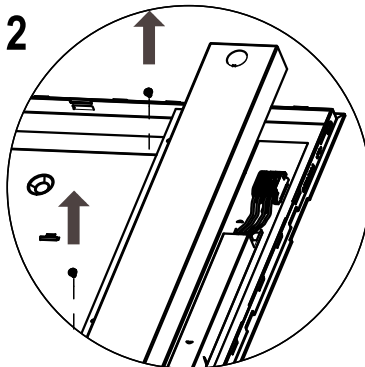

3+4

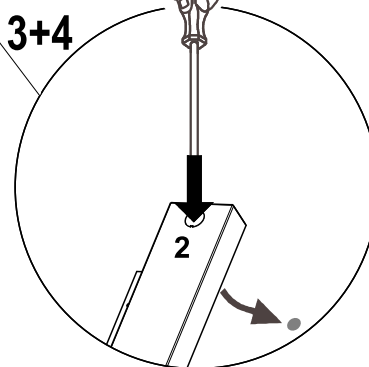

hold the  
luminaire

5



electrical  
connections



5

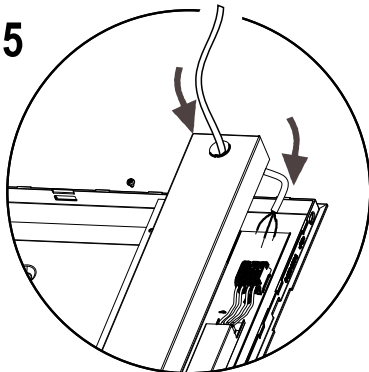

5a

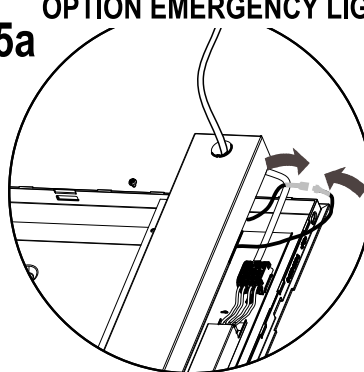

### OPTION EMERGENCY LIGHTING

6

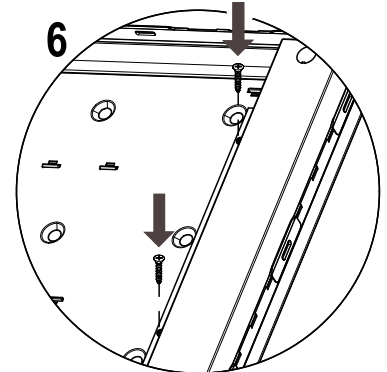

# Installation Instructions

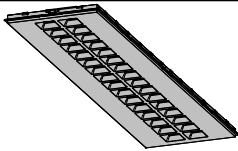

**Important Preinstallation Note:** These instructions are only for accessible ceilings (universal recessed flange or recessed flange flush mount). For other ceiling conditions, consult factory. Handle fixture carefully. Mounting to the ceiling can only be carried out by two persons. Please refer to the approved layout drawings prior to installation, if applicable.

**MIREL LED 1'x4', 2'x2' RU  
Recessed Direct Fixture  
Individual**  
For accessible Ceiling only

**DO NOT REMOVE THE LED ASSEMBLY. THIS WILL VOID THE WARRANTY. Call Zumtobel at 1-800-448-4131 for questions.**



## DANGER

### RISK OF FIRE AND ELECTRICAL SHOCK

Contact, improper installation, or improper servicing **MAY RESULT IN DEATH OR SERIOUS INJURY!**

Fixture must be installed by a qualified electrician only. Fixture is intended for installation in accordance with the National Electrical Code, local and federal code specifications. Disconnect power at electrical panel before servicing. Retain these instructions for maintenance reference.



## READ ENTIRE INSTRUCTIONS BEFORE STARTING INSTALLATION

**7 Slip luminaire into ceiling opening and place into recess flanges.**  
Make sure that the fixture tight fit into the ceiling and that the power cord does not get caught between the fixture and the ceiling.

### OPTIONAL 15/16" FLUSH INSTALLATION:

Attach all of the 8 adapters supplied to the luminaire (2 on each side).

**8 Clean-up luminaire.**  
Use a soft fluffless cloth.

**7a**

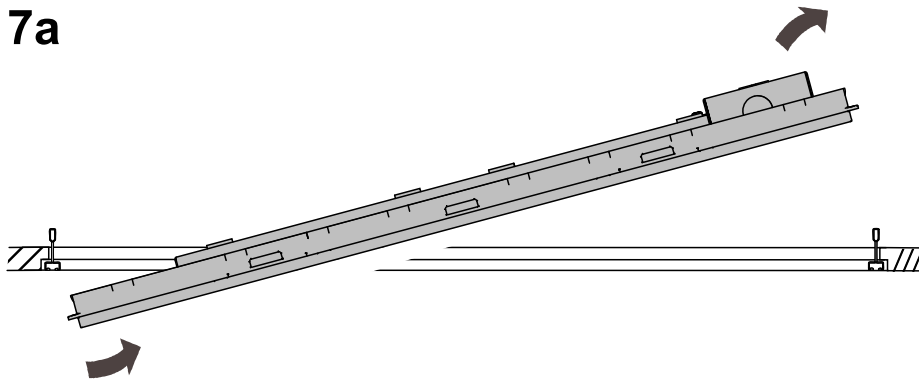

**7b**

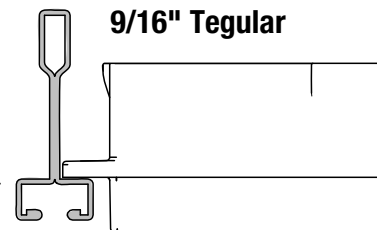
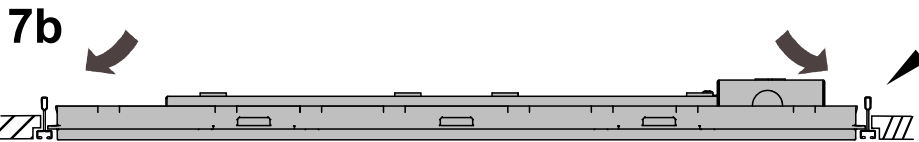

**9/16" Tegular**

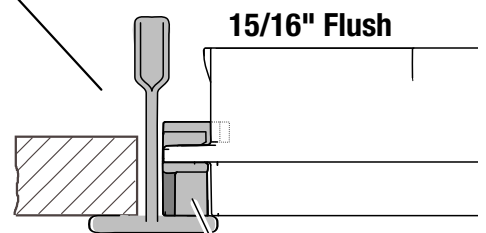

**15/16" Flush**

**OPTION  
15/16"  
FLUSH  
INSTALL**

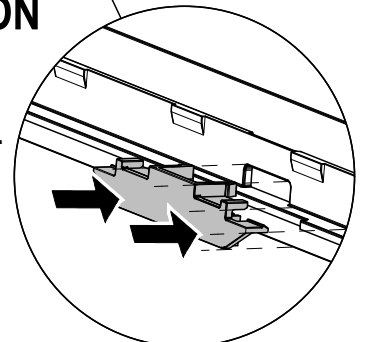

# Installation Instructions

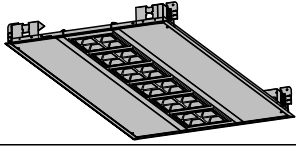

**Important Preinstallation Note:** These instructions are only for inaccessible ceilings (gypsum board or selected concealed). For other ceiling conditions, consult factory. Handle fixture carefully. Mounting to the ceiling can only be carried out by two persons. Please refer to the approved layout drawings prior to installation, if applicable.

## MIREL LED 2'x4' RE Recessed Direct Fixture Individual

For inaccessible Ceilings  
(Gypsum Board Ceilings)

**DO NOT REMOVE THE LED ASSEMBLY. THIS WILL VOID THE WARRANTY. Call Zumtobel at 1-800-448-4131 for questions.**



### DANGER

#### RISK OF FIRE AND ELECTRICAL SHOCK

Contact, improper installation, or improper servicing  
**MAY RESULT IN DEATH OR SERIOUS INJURY!**

Fixture must be installed by a qualified electrician only.  
Fixture is intended for installation in accordance with  
the National Electrical Code, local and federal code  
specifications. Disconnect power at electrical panel  
before servicing. Retain these instructions for  
maintenance reference.



### READ ENTIRE INSTRUCTIONS BEFORE STARTING INSTALLATION

#### 1 Unpack fixture.

Package contains the following parts:  
Single unit fixture. Ceiling Fixing Kit.

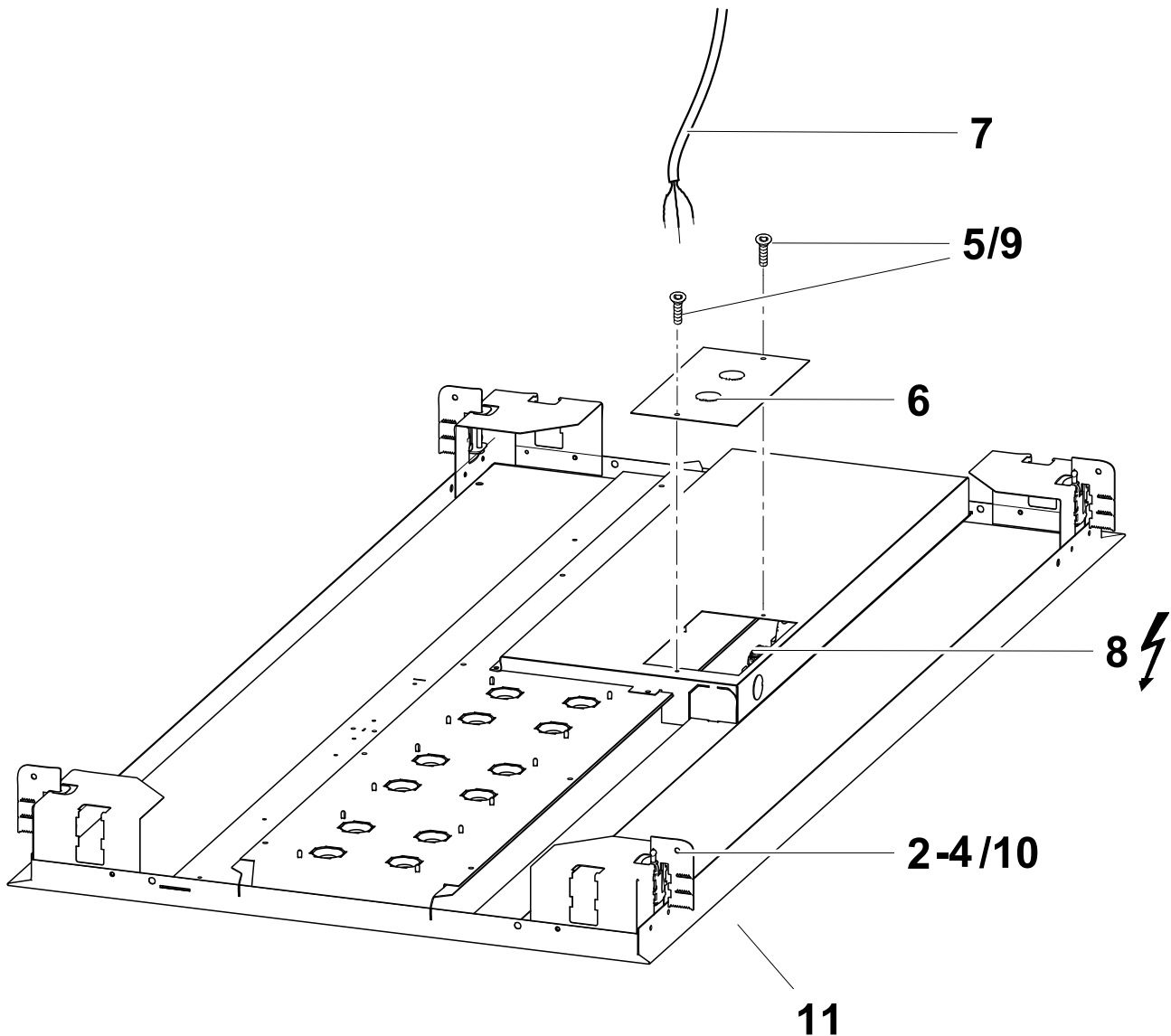



Installation Instructions

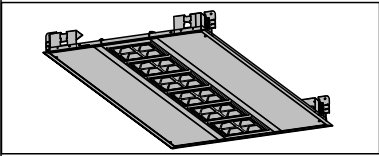

**Important Preinstallation Note:** These instructions are only for inaccessible ceilings (gypsum board or selected concealed). For other ceiling conditions, consult factory. Handle fixture carefully. Mounting to the ceiling can only be carried out by two persons. Please refer to the approved layout drawings prior to installation, if applicable.

**MIREL LED 2'x4' RE  
Recessed Direct Fixture  
Individual**  
For inaccessible Ceilings  
(Gypsum Board Ceilings)

**DO NOT REMOVE THE LED ASSEMBLY. THIS WILL VOID THE WARRANTY. Call Zumtobel at 1-800-448-4131 for questions.**

**DANGER**

**RISK OF FIRE AND ELECTRICAL SHOCK**

Contact, improper installation, or improper servicing **MAY RESULT IN DEATH OR SERIOUS INJURY!**

Fixture must be installed by a qualified electrician only. Fixture is intended for installation in accordance with the National Electrical Code, local and federal code specifications. Disconnect power at electrical panel before servicing. Retain these instructions for maintenance reference.

**READ ENTIRE INSTRUCTIONS  
BEFORE STARTING INSTALLATION**

- 2
- Prepare ceiling.  
Saw appropriate cutout into gypsum board ceiling.  
Refer to dimensions given in the table.
- 3
- Chop fixing elements to desired height (4x).  
Use pliers to break away one or two units.
- 4
- Mount fixing elements into luminaire (4x).  
(Steps 4a - d)

	L	W	L <sub>C</sub>	W <sub>C</sub>	H	H <sub>max</sub>
2' x 4'	47.9	23.9	47.1	23.1	2.95	3.94

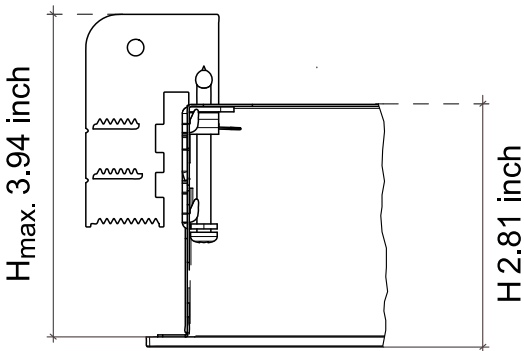

(L = Length, W = Width, L<sub>C</sub> = Length of cutout, W<sub>C</sub> = Width of cutout, H = Height of luminaire, H<sub>max</sub> = maximum Height needed for installation)

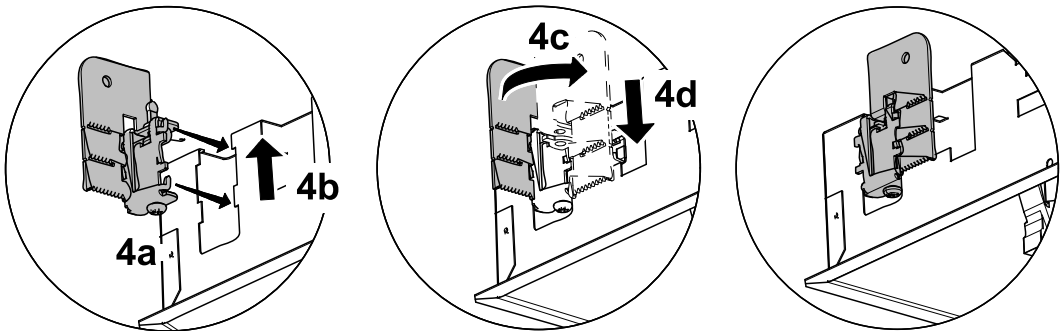
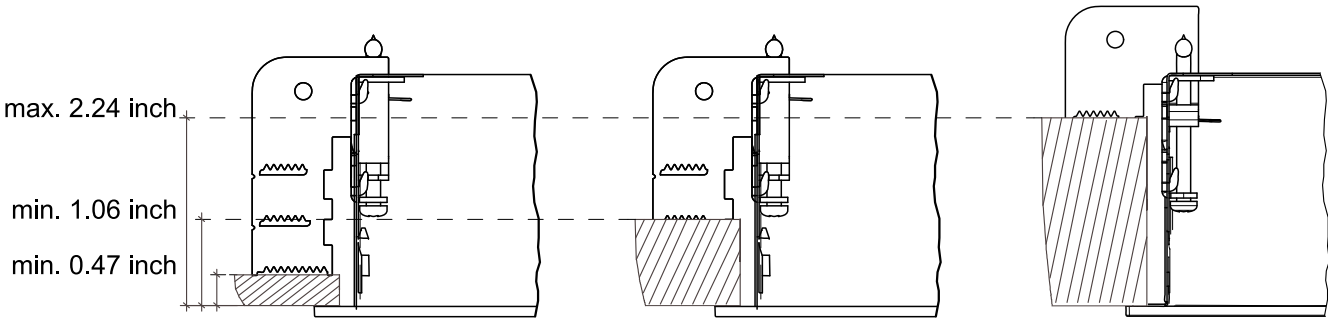

# Installation Instructions

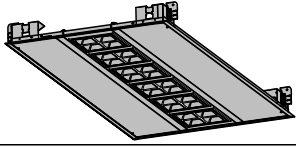

**Important Preinstallation Note:** These instructions are only for inaccessible ceilings (gypsum board or selected concealed). For other ceiling conditions, consult factory. Handle fixture carefully. Mounting to the ceiling can only be carried out by two persons. Please refer to the approved layout drawings prior to installation, if applicable.

## MIREL LED 2'x4' RE Recessed Direct Fixture Individual

For inaccessible Ceilings  
(Gypsum Board Ceilings)

**DO NOT REMOVE THE LED ASSEMBLY. THIS WILL VOID THE WARRANTY. Call Zumtobel at 1-800-448-4131 for questions.**



### DANGER

#### RISK OF FIRE AND ELECTRICAL SHOCK

Contact, improper installation, or improper servicing  
**MAY RESULT IN DEATH OR SERIOUS INJURY!**

Fixture must be installed by a qualified electrician only.  
Fixture is intended for installation in accordance with  
the National Electrical Code, local and federal code  
specifications. Disconnect power at electrical panel  
before servicing. Retain these instructions for  
maintenance reference.



### READ ENTIRE INSTRUCTIONS BEFORE STARTING INSTALLATION

#### 5 Remove cover plate of the driver box.

Loosen two screws to get access to terminal block.  
Keep screws for remounting in step 9.

#### 6 Break through knock-out opening 2.

Use a screw driver or any other appropriate tool to break through  
the cover of the driver box.

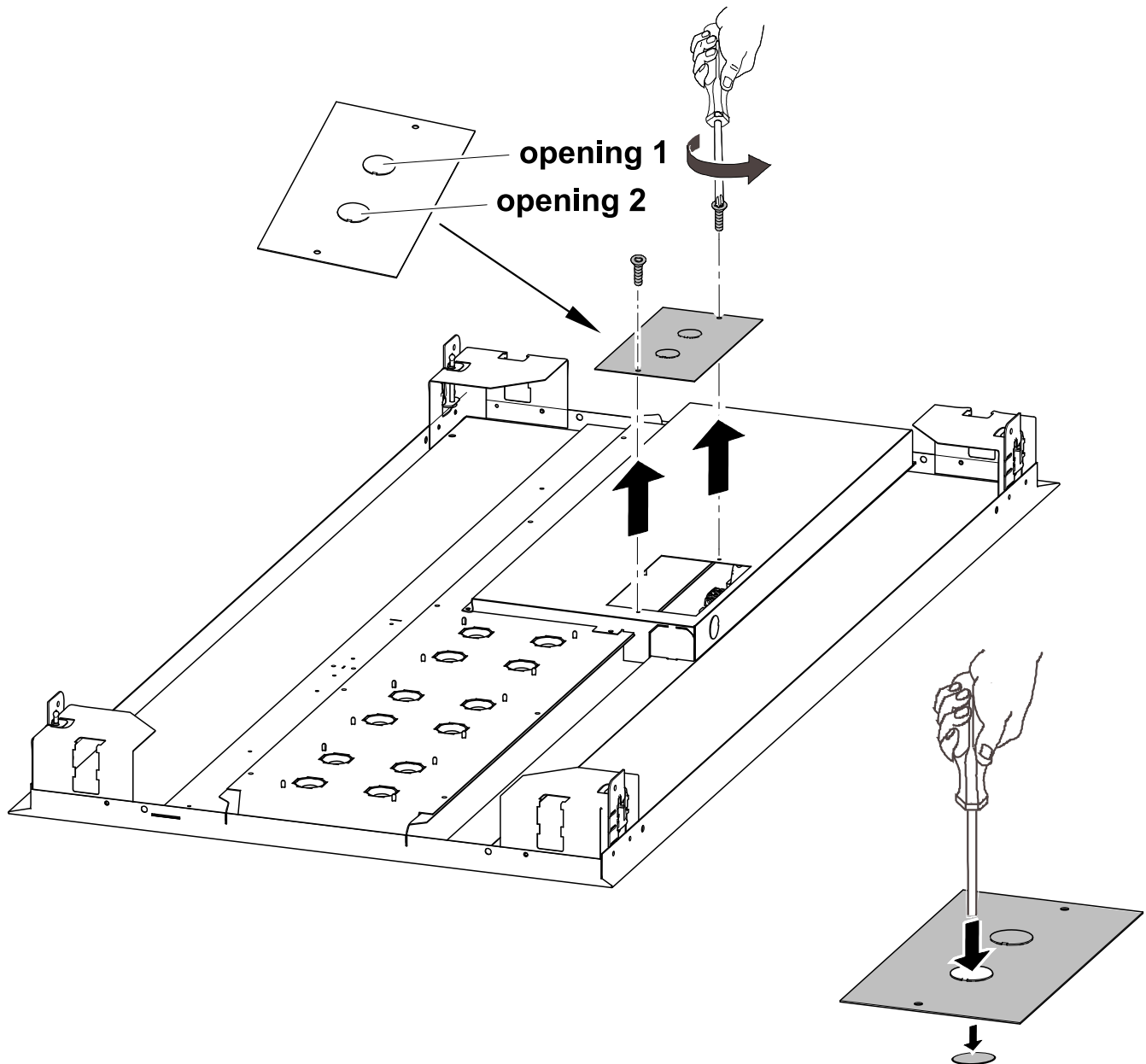

# Installation Instructions

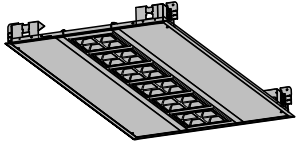

**Important Preinstallation Note:** These instructions are only for inaccessible ceilings (gypsum board or selected concealed). For other ceiling conditions, consult factory. Handle fixture carefully. Mounting to the ceiling can only be carried out by two persons. Please refer to the approved layout drawings prior to installation, if applicable.

## MIREL LED 2'x4' RE Recessed Direct Fixture Individual

For inaccessible Ceilings  
(Gypsum Board Ceilings)

**DO NOT REMOVE THE LED ASSEMBLY. THIS WILL VOID THE WARRANTY. Call Zumtobel at 1-800-448-4131 for questions.**



### DANGER

#### RISK OF FIRE AND ELECTRICAL SHOCK

Contact, improper installation, or improper servicing  
**MAY RESULT IN DEATH OR SERIOUS INJURY!**

Fixture must be installed by a qualified electrician only. Fixture is intended for installation in accordance with the National Electrical Code, local and federal code specifications. Disconnect power at electrical panel before servicing. Retain these instructions for maintenance reference.



### READ ENTIRE INSTRUCTIONS BEFORE STARTING INSTALLATION

- 7** Trim power cord to the appropriate length. Pull cord through knock-out opening 2.
- 8** Luminaire needs to be hold in place close to the ceiling. A second person makes all electrical connections to the terminal block.
- 8a** **OPTION EMERGENCY LIGHTING**  
Connect battery pack connectors to activate emergency function. See manufacturers's leaflet for further instructions (by Iota).

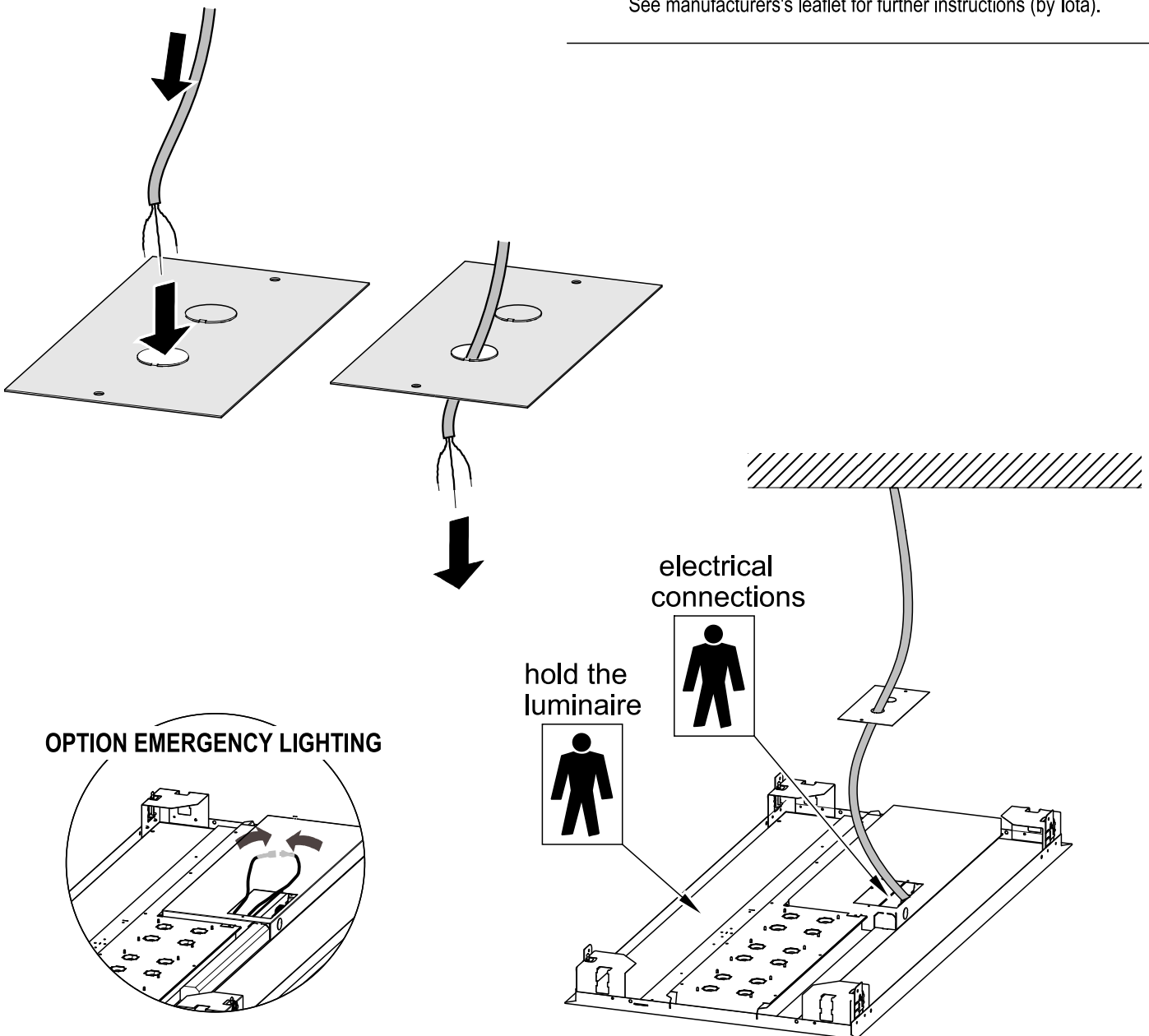

# Installation Instructions

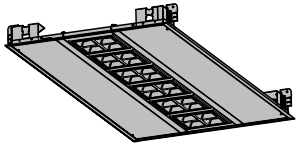

**Important Preinstallation Note:** These instructions are only for inaccessible ceilings (gypsum board or selected concealed). For other ceiling conditions, consult factory. Handle fixture carefully. Mounting to the ceiling can only be carried out by two persons. Please refer to the approved layout drawings prior to installation, if applicable.

## MIREL LED 2'x4' RE Recessed Direct Fixture Individual

For inaccessible Ceilings  
(Gypsum Board Ceilings)

**DO NOT REMOVE THE LED ASSEMBLY. THIS WILL VOID THE WARRANTY. Call Zumtobel at 1-800-448-4131 for questions.**



### DANGER

#### RISK OF FIRE AND ELECTRICAL SHOCK

Contact, improper installation, or improper servicing  
**MAY RESULT IN DEATH OR SERIOUS INJURY!**

Fixture must be installed by a qualified electrician only.  
Fixture is intended for installation in accordance with  
the National Electrical Code, local and federal code  
specifications. Disconnect power at electrical panel  
before servicing. Retain these instructions for  
maintenance reference.



### READ ENTIRE INSTRUCTIONS BEFORE STARTING INSTALLATION

- 9** Fix cover plate of the driver box again.  
Use the screws which were removed in step 5.

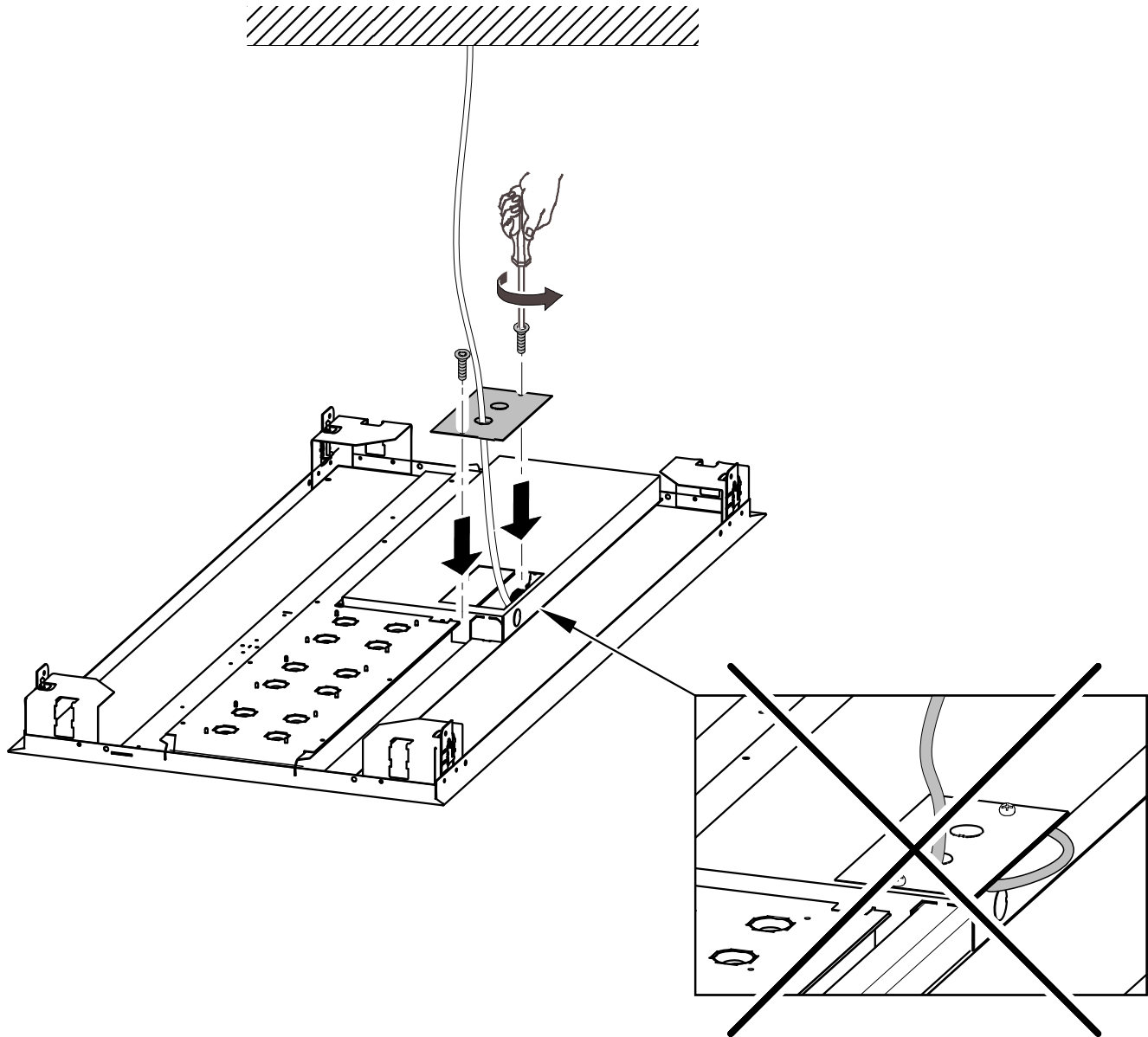

A technical drawing of a bridge deck cross-section. It shows a central truss structure with a series of vertical members and diagonal bracing. The truss is supported by a central pier and two side piers. The deck is shown as a flat surface on top of the truss. The drawing is a perspective view, showing the bridge from an angle.

**MIREL LED 2'x4' RE**  
**Recessed Direct Fixture**  
**Individual**  
 For inaccessible Ceilings  
 (Gypsum Board Ceilings)

**DANGER**

**RISK OF FIRE AND ELECTRICAL SHOCK**

Contact, improper installation, or improper servicing  
**MAY RESULT IN DEATH OR SERIOUS INJURY!**

Fixture must be installed by a qualified electrician only.  
Fixture is intended for installation in accordance with  
the National Electrical Code, local and federal code  
specifications. Disconnect power at electrical panel  
before servicing. Retain these instructions for  
maintenance reference.

**10 Install luminaire into the ceiling.**  
Snap out the fixing elements (4x).  
Tighten the screws. Pay attention to correct fixation.  
Close dummy plugs (4x).

**11 Clean-up luminaire.**  
Use a soft fluffless cloth.

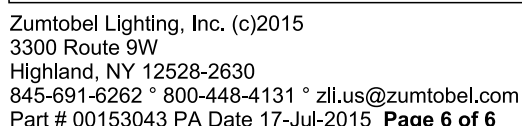
**ZUMTOBEL**



# Installation Instructions

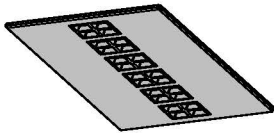

**Important Preinstallation Note:** These instructions are only for accessible ceilings (universal recessed flange or recessed flange flush mount). For other ceiling conditions, consult factory. Handle fixture carefully. Mounting to the ceiling can only be carried out by two persons. Please refer to the approved layout drawings prior to installation, if applicable.

**MIREL LED 2'x4' RU/RF  
Recessed Direct Fixture  
Individual**  
For accessible Ceilings only

**DO NOT REMOVE THE LED ASSEMBLY. THIS WILL VOID THE WARRANTY. Call Zumtobel at 1-800-448-4131 for questions.**



## DANGER

### RISK OF FIRE AND ELECTRICAL SHOCK

Contact, improper installation, or improper servicing  
**MAY RESULT IN DEATH OR SERIOUS INJURY!**

Fixture must be installed by a qualified electrician only.  
Fixture is intended for installation in accordance with  
the National Electrical Code, local and federal code  
specifications. Disconnect power at electrical panel  
before servicing. Retain these instructions for  
maintenance reference.



## READ ENTIRE INSTRUCTIONS BEFORE STARTING INSTALLATION

### 1 Unpack fixture.

Package contains the following parts:  
Single unit fixture.

**RU**

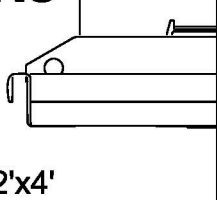

2'x4'

Universal recessed flange  
for 15/16" flush and 9/16"  
tegar mount

**RF**

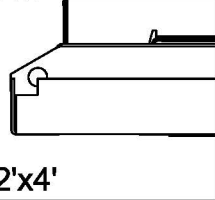

2'x4'

Recessed flange  
for 9/16" flush mount

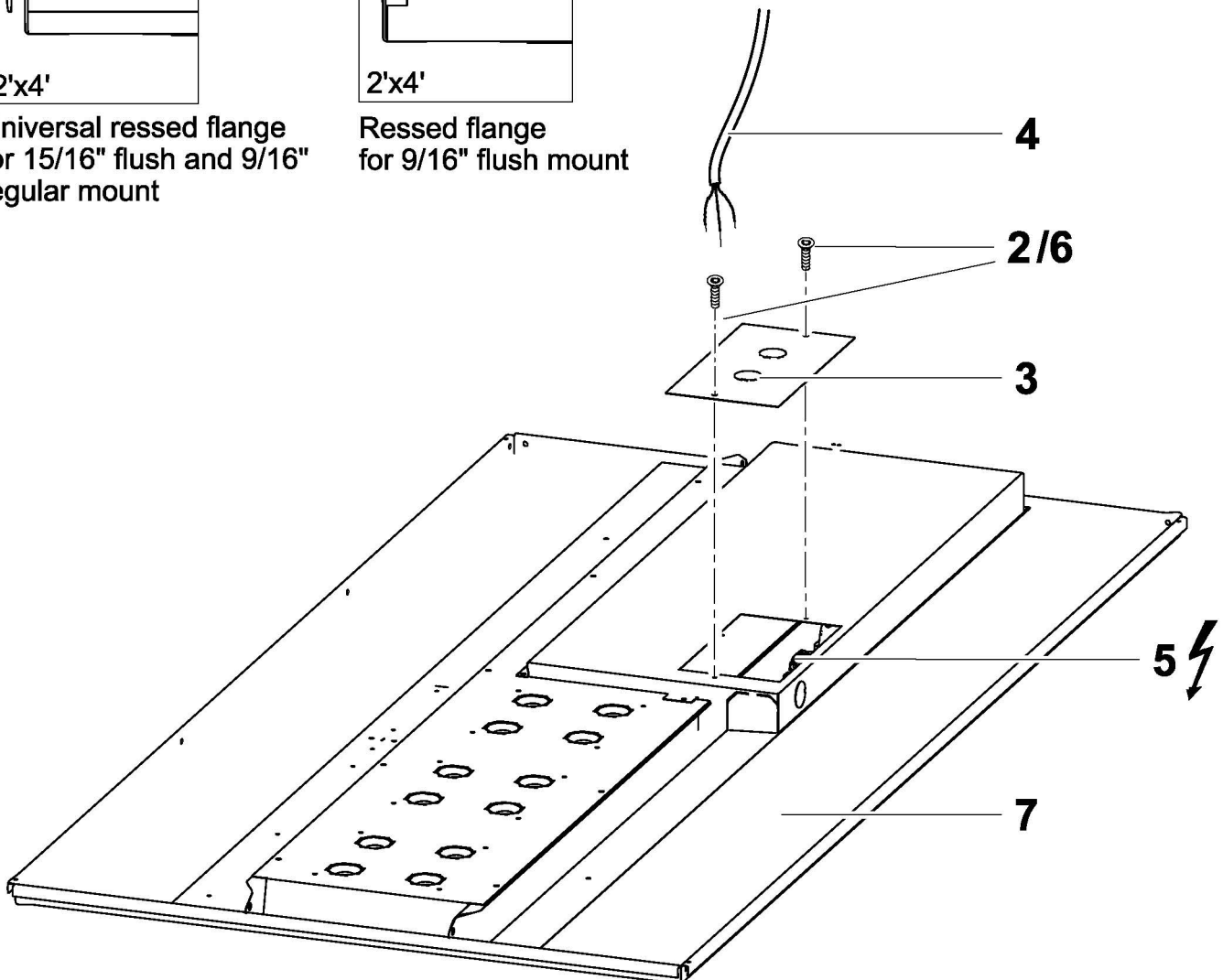

# Installation Instructions

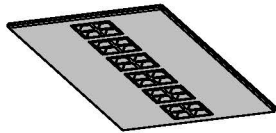

**Important Preinstallation Note:** These instructions are only for accessible ceilings (universal recessed flange or recessed flange flush mount). For other ceiling conditions, consult factory. Handle fixture carefully. Mounting to the ceiling can only be carried out by two persons. Please refer to the approved layout drawings prior to installation, if applicable.

**MIREL LED 2'x4' RU/RF  
Recessed Direct Fixture  
Individual**  
For accessible Ceilings only

**DO NOT REMOVE THE LED ASSEMBLY. THIS WILL VOID THE WARRANTY. Call Zumtobel at 1-800-448-4131 for questions.**



## DANGER

### RISK OF FIRE AND ELECTRICAL SHOCK

Contact, improper installation, or improper servicing  
**MAY RESULT IN DEATH OR SERIOUS INJURY!**

Fixture must be installed by a qualified electrician only. Fixture is intended for installation in accordance with the National Electrical Code, local and federal code specifications. Disconnect power at electrical panel before servicing. Retain these instructions for maintenance reference.



## READ ENTIRE INSTRUCTIONS BEFORE STARTING INSTALLATION

### 2 Remove cover plate of the driver.

Loosen two screws to get access to terminal block.  
Keep screws for remounting in step 5.

### 3 Break through knock-out opening 2.

Use a screw driver or any other appropriate tool to break through the cover of the driver box.

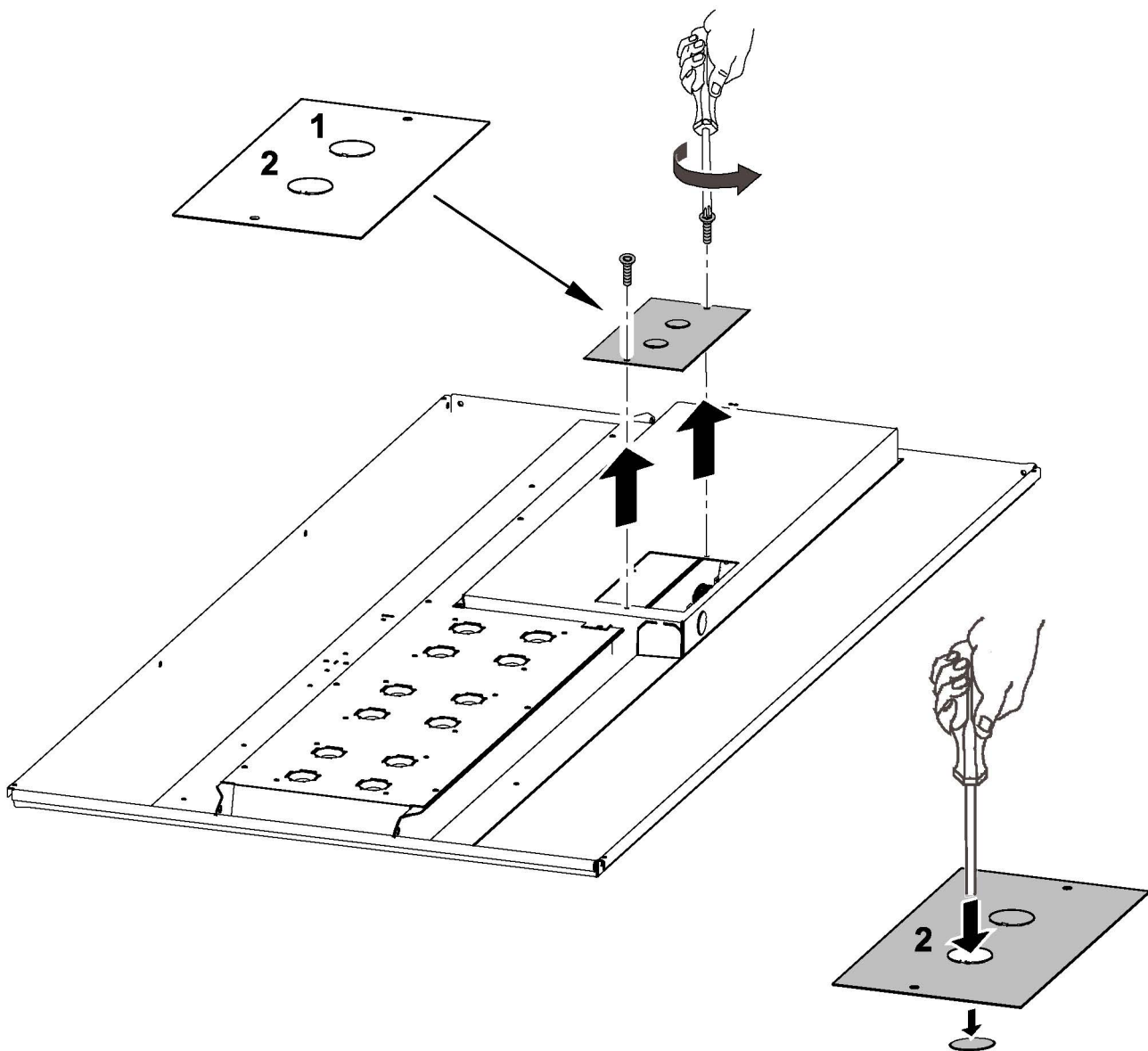

# Installation Instructions

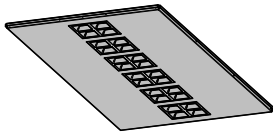

**Important Preinstallation Note:** These instructions are only for accessible ceilings (universal recessed flange or recessed flange flush mount). For other ceiling conditions, consult factory. Handle fixture carefully. Mounting to the ceiling can only be carried out by two persons. Please refer to the approved layout drawings prior to installation, if applicable.

**MIREL LED 2'x4' RU/RF  
Recessed Direct Fixture  
Individual**  
For accessible Ceilings only

**DO NOT REMOVE THE LED ASSEMBLY. THIS WILL VOID THE WARRANTY. Call Zumtobel at 1-800-448-4131 for questions.**



## DANGER

### RISK OF FIRE AND ELECTRICAL SHOCK

Contact, improper installation, or improper servicing **MAY RESULT IN DEATH OR SERIOUS INJURY!**

Fixture must be installed by a qualified electrician only. Fixture is intended for installation in accordance with the National Electrical Code, local and federal code specifications. Disconnect power at electrical panel before servicing. Retain these instructions for maintenance reference.



## READ ENTIRE INSTRUCTIONS BEFORE STARTING INSTALLATION

- 4** Trim power cord to the appropriate length. Pull cord through knock-out opening 2.
- 5** Luminaire needs to be hold in place close to the ceiling. A second person makes all electrical connections to the terminal block.
- 5a** **OPTION EMERGENCY LIGHTING** Connect battery pack connectors to activate emergency function. See manufacturer's leaflet for further instructions (by lota).

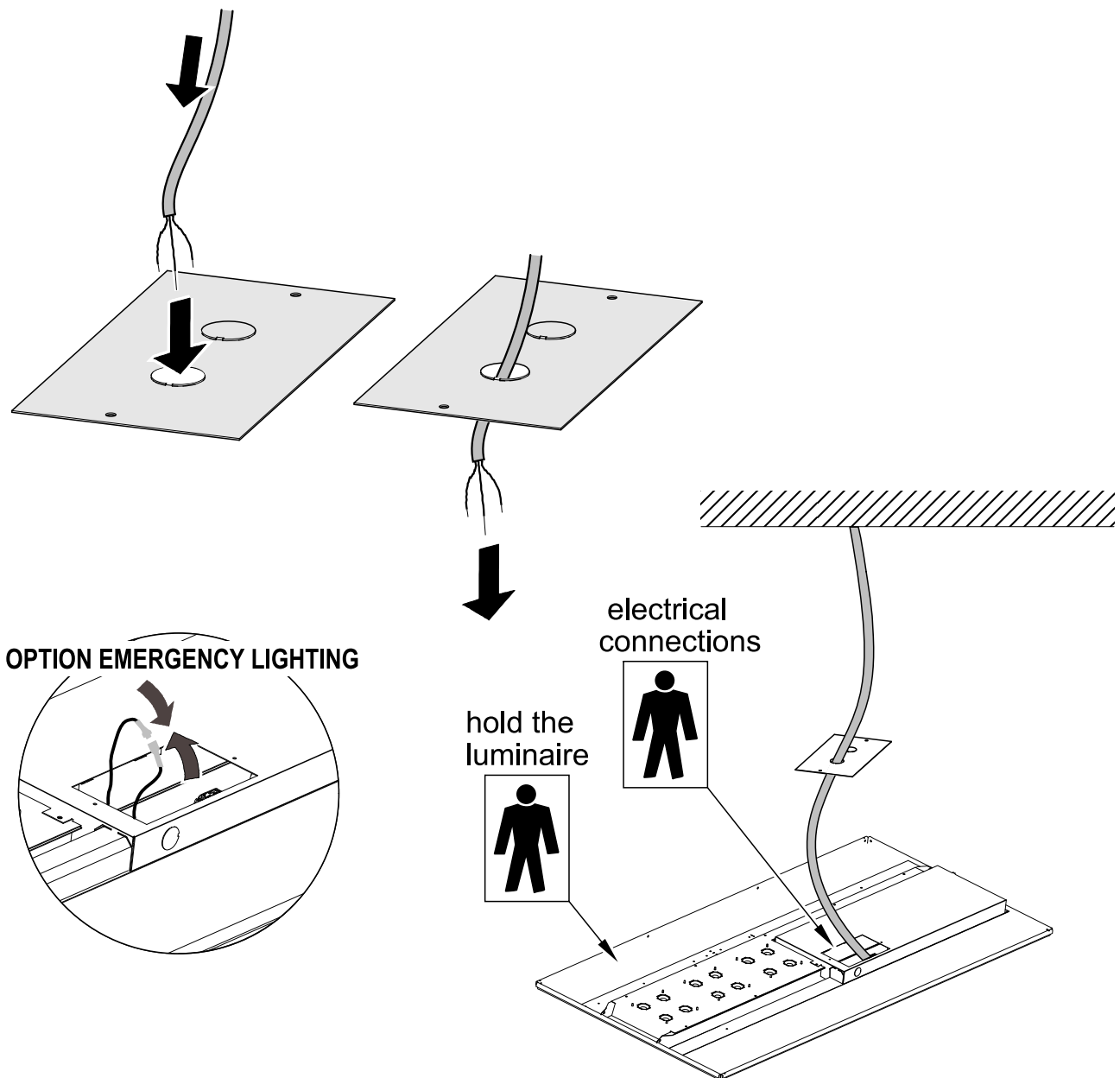

# Installation Instructions

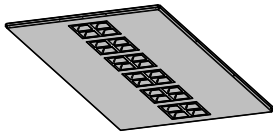

**Important Preinstallation Note:** These instructions are only for accessible ceilings (universal recessed flange or recessed flange flush mount). For other ceiling conditions, consult factory. Handle fixture carefully. Mounting to the ceiling can only be carried out by two persons. Please refer to the approved layout drawings prior to installation, if applicable.

**MIREL LED 2'x4' RU/RF  
Recessed Direct Fixture  
Individual**  
For accessible Ceilings only

**DO NOT REMOVE THE LED ASSEMBLY. THIS WILL VOID THE WARRANTY. Call Zumtobel at 1-800-448-4131 for questions.**



## DANGER

### RISK OF FIRE AND ELECTRICAL SHOCK

Contact, improper installation, or improper servicing  
**MAY RESULT IN DEATH OR SERIOUS INJURY!**

Fixture must be installed by a qualified electrician only.  
Fixture is intended for installation in accordance with  
the National Electrical Code, local and federal code  
specifications. Disconnect power at electrical panel  
before servicing. Retain these instructions for  
maintenance reference.



## READ ENTIRE INSTRUCTIONS BEFORE STARTING INSTALLATION

- 6** Fix cover plate of the driver box again.  
Use the screws which were removed in step 2.

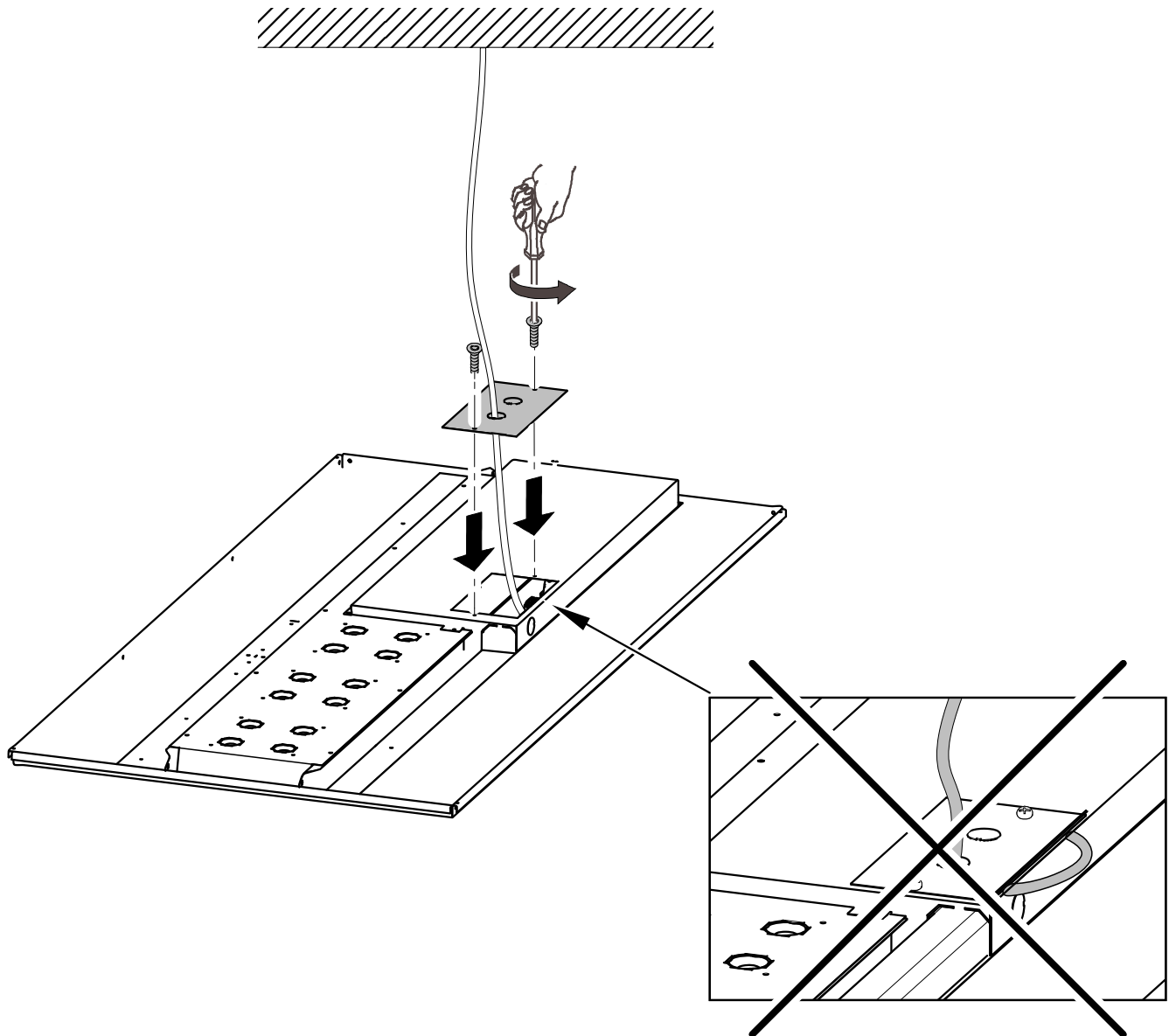

# Installation Instructions

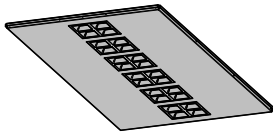

**Important Preinstallation Note:** These instructions are only for accessible ceilings (universal recessed flange or recessed flange flush mount). For other ceiling conditions, consult factory. Handle fixture carefully. Mounting to the ceiling can only be carried out by two persons. Please refer to the approved layout drawings prior to installation, if applicable.

**MIREL LED 2'x4' RU/RF  
Recessed Direct Fixture  
Individual**  
For accessible Ceilings only

**DO NOT REMOVE THE LED ASSEMBLY. THIS WILL VOID THE WARRANTY. Call Zumtobel at 1-800-448-4131 for questions.**



## DANGER

### RISK OF FIRE AND ELECTRICAL SHOCK

Contact, improper installation, or improper servicing **MAY RESULT IN DEATH OR SERIOUS INJURY!**  
Fixture must be installed by a qualified electrician only. Fixture is intended for installation in accordance with the National Electrical Code, local and federal code specifications. Disconnect power at electrical panel before servicing. Retain these instructions for maintenance reference.



## READ ENTIRE INSTRUCTIONS BEFORE STARTING INSTALLATION

- 7 Slip luminaire into ceiling opening and place into recess flanges.**  
Make sure power cord does not get caught between housing and luminaire.  
Pay attention that luminaire and housing tight fit into the ceiling.
- 8 Clean-up luminaire.**  
Use a soft fluffless cloth.

