

2.5" Recessed

LOUVER OPTIC OPTIONS

SLOTLIGHT LED III

2.5" Individual Luminaires and Straight Runs

- Continuous line of light
- Chicago Plenum available
- Available in a variety of lengths to suit any application
- Available with occupancy and daylight sensors
- UGR <19 with specific louver options



Suitable for Damp or Wet Locations**

PROGRAMMABLE LM/FT RANGES *

OPTIC	3000 K		3500 K		4000 K	
	MIN	MAX	MIN	MAX	MIN	MAX
Matte Black Louver	183	443	187	454	190	461
Gloss Black Louver	177	430	182	441	184	448
Silver Louver	314	761	321	780	326	792
White Louver	429	1042	440	1067	447	1084
Indirect Batwing	411	1120	421	1147	427	1155
Indirect Asymmetric	135	734	138	752	139	760

* Exact programming levels available as a modification.

Order Code

1	2	3	4	5	6	7	8	9	10	11	12	13	14	15
1 FIXTURE	SL3I Individual ¹ SL3R Run ²													
2 WIDTH	2 2.5"													
3 MOUNTING	FL Flanged, Sheetrock EA Flangeless, After Sheetrock EB Flangeless, Before Sheetrock PM Perimeter Mount, Before Sheetrock IN Lay-in, 9/16" Flush IW Lay-in, 15/16" Flush SG Lay-in, 9/16" Slotgrid or Tegular IT Lay-in, 15/16" Slotgrid or Tegular PN Perimeter Mount, 9/16" Lay-in Flush PW Perimeter Mount, 15/16" Lay-in Flush PG Perimeter Mount, 9/16" Slotgrid or Tegular PT Perimeter Mount, 15/16" Slotgrid or Tegular TW TechZone or Logix 9/16" Flush TG TechZone or Logix 9/16" Slotgrid or Tegular													
4 WHOLE LENGTH	XXX Length in 1" Increments (Minimum Length is 4')													
5 DIRECT OUTPUT	08 800 lm/ft 07 700 lm/ft 06 600 lm/ft 05 500 lm/ft 04 400 lm/ft													
6 DIRECT OPTIC	W Matte White Louver ³ G Gloss Black Louver ⁴ B Matte Black Louver ⁴ S Matte Silver Louver ⁵													
7 CRI	9 90 CRI													
8 CCT	30 3000 K 35 3500 K 40 4000 K													
9 DRIVER	U 0-10 V, 1%, 120 V / 277 V D DALI, 1%, 120 V / 277 V H Lutron EcoSystem, 1%, 120 V / 277 V C 0-10 V, 1%, 347 V													
10 FINISH	W White S Silver B Black													
11 CONTROL OPTIONS	N None E Enlighted ⁶ W Wireless ⁶													
12 ACCESSORIES *	C EM Circuit ⁷ B Battery ⁸													
13 EM START	1 Start EM 0 None													
14 EM MID	X Quantity from 1 to 9 0 None													
15 EM END	1 End EM 0 None													

* ONLY COMPLETE 12-15 IF EMERGENCY OPTIONS ARE REQUIRED

- Must be between 4' and 8' in length.
- Minimum length is 9'.
- Matte White Louver is only available with 800 lm/ft, 700 lm/ft and 600 lm/ft packages.
- Matte and gloss black louvers are only available with 400 lm/ft package.
- Matte Silver Louver is only available with 600 lm/ft, 500 lm/ft and 400 lm/ft packages.
- Only available with 0-10 V dimming.
- Add EM circuit option when designating only a portion of a continuous run is to be circuited for emergency. If an entire fixture or entire run is EM circuit then this option is provided as standard.
- EM battery available in 4' sections only. EM battery is not available with 347 V driver option.

We reserve the right to change, without notice, specifications or materials. Supporting documentation found on zumtobel.us are the most recent versions and supersede all other versions that exist in any other printed or electronic form.

Lumens

		DIRECT							
		Matte White Louver			Matte Black Louver	Gloss Black Louver	Matte Silver Louver		
		600	700	800	400	400	400	500	600
3000 K	LM/W	94	93	92	59	37	69	68	67
	W/ft	6.4	7.5	8.7	10.4	10.7	5.8	7.3	8.9
3500 K	LM/W	97	95	94	40	38	71	70	69
	W/ft	6.2	7.3	8.5	10.1	10.5	5.6	7.1	8.7
4000 K	LM/W	98	97	96	40	39	72	71	70
	W/ft	6.1	7.2	8.3	9.9	10.3	5.5	7.0	8.5

Optical Performance

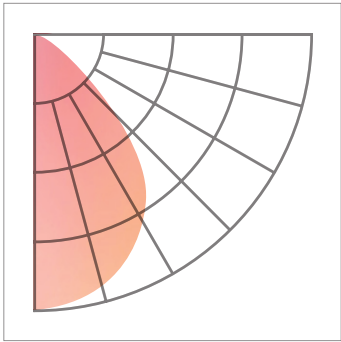

GLOSS BLACK LOUVER | 800 LM/FT | 935

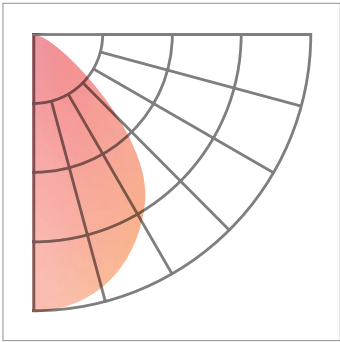

MATTE BLACK LOUVER | 600 LM/FT | 935

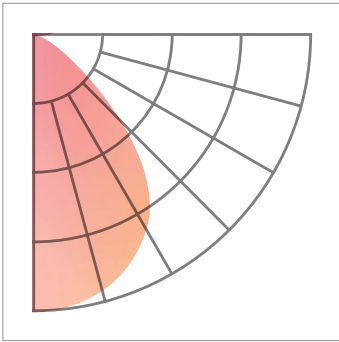

MATTE WHITE LOUVER | 800 LM/FT | 935



MATTE SILVER LOUVER | 600 LM/FT | 935

— Average Luminance cd/m² —

Vertical Angle	Horizontal Angle 0°
0	16200
45	2647
55	259
65	8
75	0
85	0

— Average Luminance cd/m² —

Vertical Angle	Horizontal Angle 0°
0	16450
45	2751
55	311
65	67
75	0
85	0

— Average Luminance cd/m² —

Vertical Angle	Horizontal Angle 0°
0	20830
45	8415
55	5654
65	4619
75	3034
85	1221

— Average Luminance cd/m² —

Vertical Angle	Horizontal Angle 0°
0	17940
45	6868
55	4132
65	2313
75	563
85	43

We reserve the right to change, without notice, specifications or materials. Supporting documentation found on zumtobel.us are the most recent versions and supersede all other versions that exist in any other printed or electronic form.

Louver Dimensions

GRID CEILING, SG 48" INDIVIDUAL

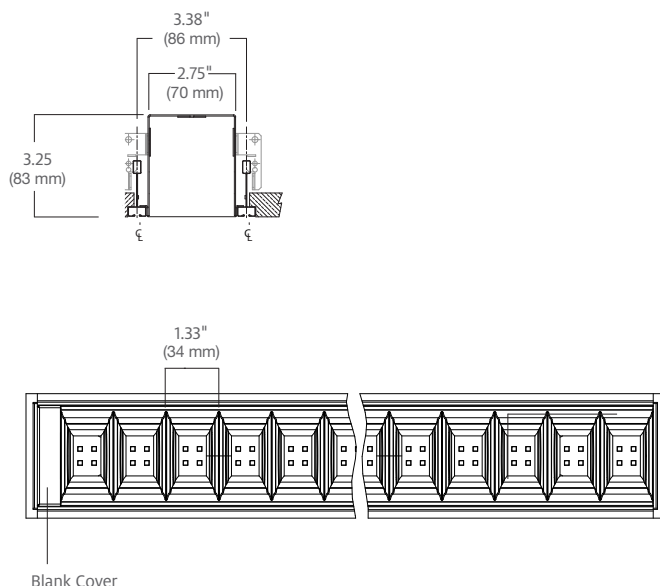

SHEETROCK CEILING, EA 48" INDIVIDUAL

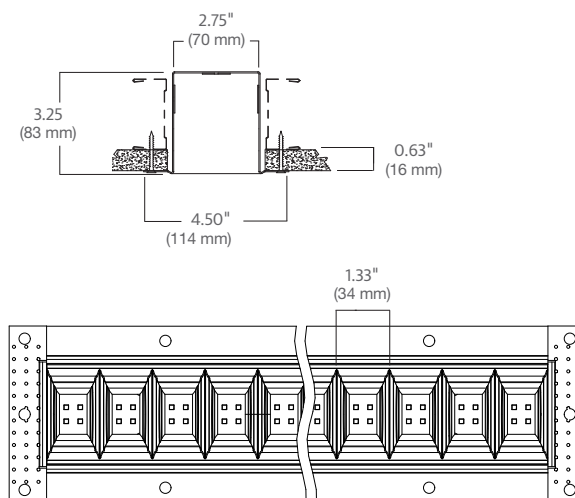

Technical Detail

1) Construction: The luminaire consists of a painted sheet metal housing and a choice of opal/clear polycarbonate roll optics with integrated continuous feed wiring.

2) Wattage & CCT: Fixture is available in lumen packages of 800 lm/ft, 700 lm/ft, 600 lm/ft, 500 lm/ft and 400 lm/ft. Wattage is determined by lumen package and CCT chosen. Available in 3000 K, 3500 K or 4000 K color temperatures with 90+ CRI. 3-Step MacAdam Ellipse.

3) Drivers: The unit is available with standard 120 V / 277 V 0-10 V dimming driver (1%), 347 V 0-10 V dimming driver (1%), Lutron LDE1 Hi-Lume 1% digital EcoSystem with SoftOn/FadeToBlack, or DALI dimming driver (1%). For non-dimming applications a 0-10 V driver will be provided, cap off the two control wires and connect the hot/neutral and ground as normal. Wireless dimming is only available with all 0-10 V driver options. Tunable White fixtures have the option of DALI controlled dimming signal or Osram Dexal. If Osram Dexal is a requirement compatible control interfaces must be purchased directly from Osram. DALI dimming option uses protocol 8. Wireless dimming is available through eidoLED BLE radio and controlled by 4remote BT app or Bluetooth switches.

4) Optic: The unit is available with choice of injection molded louvers for visual comfort. If UGR <19 is a project requirement please order the fixture with either black or silver louver options. White louvers do not meet UGR <19 Requirements.

5) Mounting: Perimeter Mounting option is provided for wall-to-wall applications. Please see mounting details on pages 4 and 5 for dimensions and more information on all other mounting options.

6) Length: Individual fixtures and straight runs lengths can be ordered in exact length increments of 1' with a 4' minimum. Lengths of 8' and under are provided as individual fixtures. Lengths greater than 8' are provided as runs comprising of start, middle and end sections.

Configurations total length should be measured from the outside perimeter of the configuration to the nearest foot. Shop drawings with the exact configuration measurements will be provided with all configuration orders for approval.

7) Controls: Fixtures can be purchased with Enlightened ready controls and daylight saving/occupancy sensor, this option requires an

Enlightened compatible control interface provided by others to function. All orders with a sensor chosen will be provided with drawings showing the exact sensor placement.

8) Emergency Options: Fixtures can be either purchased for emergency circuit or emergency battery operation. EM Battery fixtures are available in 4' sections only and can be ordered as start, middle or end fixtures. The factory will consult with the client for EM placement on configurations. Average Lumen output for EM Battery is 600 Lumens.

9) Life: 50,000 hours, L85.

10) Weight: 4.45 lbs per 2 ft.

11) Declare Information:

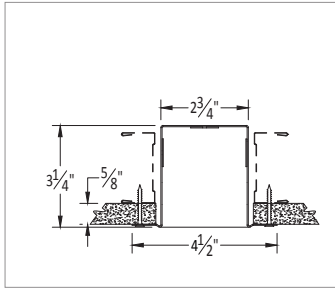
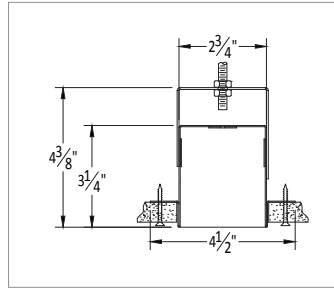
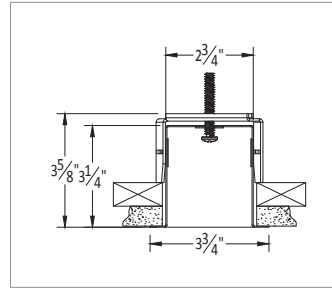
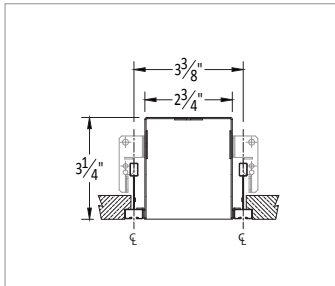
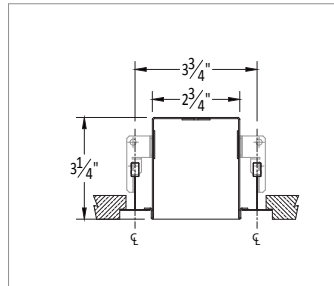
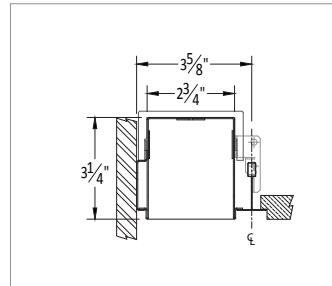
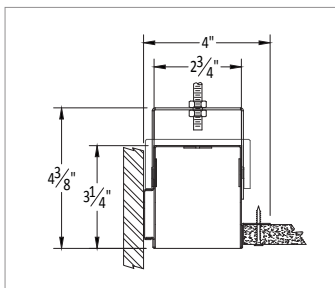
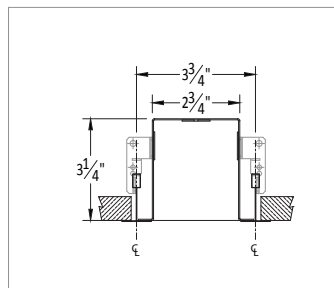
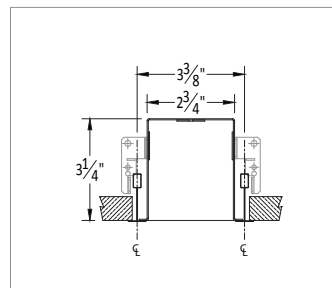
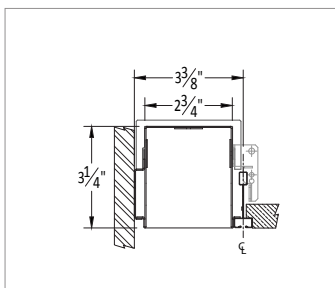
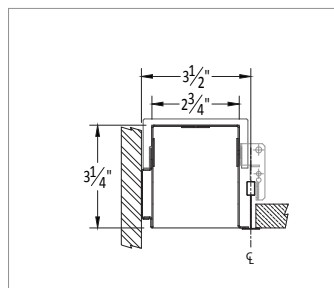
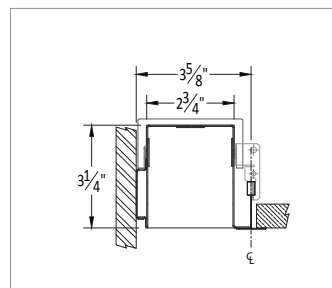
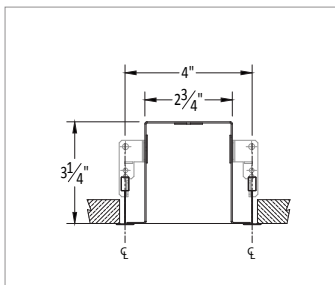
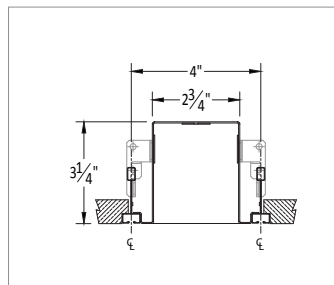

2.5" Recessed | Flush Louver

EA | Flangeless, After Sheetrock**EB | Flangeless, Before Sheetrock****FL | Flanged, Sheetrock****SG | Lay-in, 9/16" Grid****IT | Lay-in, 15/16" Grid****PT | Perimeter Mount, 15/16" Grid****PM | Perimeter Mount, Before Sheetrock****IW | Lay-in, 15/16" Flush****IN | Lay-in, 9/16" Flush****PG | Perimeter Mount, 9/16" Grid****PN | Perimeter Mount, 9/16" Lay-in Flush****PW | Perimeter Mount, 15/16" Lay-in Flush****TW | Perimeter Mount, 9/16" Grid****TG | Perimeter Mount, 9/16" Lay-in Flush**

2.5" Recessed | Recessed Corners

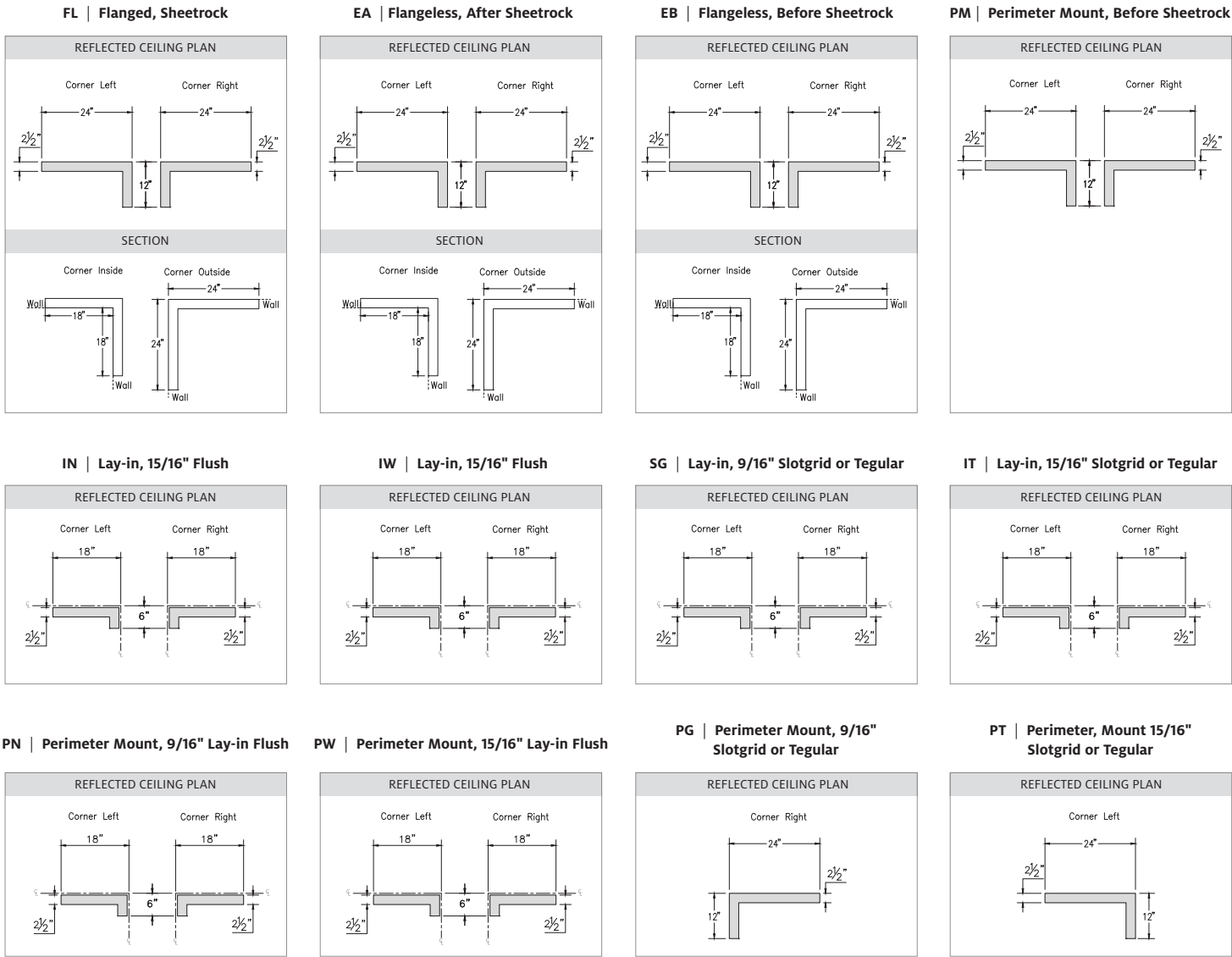

This specification sheet is not intended as a guide for installations. The dimensions are not intended for ceiling, mechanical, or electrical trades to use as an installation instruction. All trades must use the installation instructions provided on the Zumtobel Lighting Inc. website. Failure to use the installation instructions will void our product warranty.