

4" Surface Mount



LENS OPTIC OPTIONS

SLOTLIGHT LED III

4" Individual Luminaires and Straight Runs

- Continuous line of light
- Available in a variety of lengths to suit any application
- Patented roll lens for seamless installation
- Rollable lens for all direct optics: opal flush / regressed (150' max length) and asymmetric (50' max length)
- Uniformly illuminated corners
- Available with occupancy and daylight sensors



Suitable for Damp and Wet Locations

PROGRAMMABLE LM/FT RANGES *

OPTIC	3000 K		3500 K		4000 K	
	MIN	MAX	MIN	MAX	MIN	MAX
Opal	349	955	358	978	361	988
LRO	293	801	300	820	303	829
Asymmetric	198	1081	203	1107	205	1107
Indirect Batwing	450	1221	459	1250	453	1263
Indirect Asymmetric	143	790	147	799	148	807

* Exact programming levels available as a modification.

Order Code

1	4	SM	4	5	6	7	9	9	10	11	12	13	14	15	16
---	---	----	---	---	---	---	---	---	----	----	----	----	----	----	----

1	FIXTURE	SL3I Individual ¹ SL3R Run ²
2	WIDTH	4 4"
3	MOUNTING	SM Surface Mount
4	WHOLE LENGTH	XXXX Length in 1" Increments
5	FRACTIONAL LENGTH	N 0/8 A 1/8 B 2/8 C 3/8 D 4/8 E 5/8 F 6/8 G 7/8
6	DIRECT OUTPUT	09 900 lm/ft 08 800 lm/ft 07 700 lm/ft 06 600 lm/ft 05 500 lm/ft 04 400 lm/ft
7	DIRECT OPTIC	P Opal Flush (Roll Optics) L Luminance Reducing ³ A Asymmetric (Roll Optics) ³ N None
8	CRI	9 90 CRI
9	CCT	30 3000 K 35 3500 K 40 4000 K 00 Tunable White 2700-6500 K ⁴ ZS Zumtobel SPECTRUM ⁴
10	DRIVER	U 0-10 V, 1%, 120 V / 277 V D DALI, 1%, 120V / 277 V H Lutron EcoSystem, 1%, 120 V / 277V C 0-10 V, 1%, 347 V T Tunable White DALI Signal
11	FINISH	W White S Silver B Black
12	CONTROL OPTIONS	N None E Enlighted ⁵ W Wireless ⁵
13	ACCESSORIES *	C EM Circuit ⁶ B EM Battery ⁷ P Chicago Plenum N Chicago Plenum and EM Circuit ⁶ E Chicago Plenum and EM Battery ⁷
14	EM START	1 Start EM 0 None
15	EM MID	X Quantity from 1 to 9 0 None
16	EM END	1 End EM 0 None

* COMPLETE 16-19 IF EMERGENCY OPTIONS ARE REQUIRED

- Must be between 24" and 96" in length. Individual fixtures will be provided with roll optic installed.
- Minimum length is 96-1/8". Roll optic for run lengths will ship separately and need to be ordered as an additional line item.
- Luminance Reducing Optic is only available in 600 lm/ft, 500 lm/ft and 400 lm/ft packages. Asymmetric Optics only available with 400 lm/ft, 500 lm/ft and 600 lm/ft packages.
- Tunable White and Zumtobel SPECTRUM fixtures must be 4' or over in length and can only be supplied in 1' increments. Tunable White and Zumtobel SPECTRUM are not available with Asymmetric Optics. Must be ordered with T driver option.
- Only available with 0-10 V dimming. Enlighted Control not available with wet or damp rating.
- Add EM circuit option when designating only a portion of a continuous run to be circuited for emergency. If an entire fixture or entire run is EM then this option is provided as standard.
- EM battery available in 4' or greater sections. EM battery is not available with 347 V driver option. EM battery not available with wet location rating.



ZUMTOBEL

RECESSED

PENDANT / WALL MOUNT

SURFACE

4" Surface Mount Corner

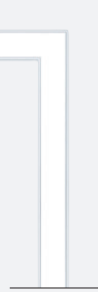

LENS OPTIC OPTIONS

SLOTLIGHT LED III

4" Configuration with Corners

- Continuous line of light
- Available in a variety of lengths to suit any application
- Patented roll lens for seamless installation
- Rollable lens for all direct optics: opal flush / regressed (150' max length) and asymmetric (50' max length)
- Uniformly illuminated corners
- Available with occupancy and daylight sensors



Suitable for Damp and Wet Locations

Order Code

SL3C	4	SM	4	5	6	7	8	9	10	11	12	13	14	15	16
1	FIXTURE	SL3C Configurations													
2	WIDTH	4 4"													
3	MOUNTING	SM Surface Mount													
4	WHOLE LENGTH	XXXX Length in 1" Increments													
5	TYPE	L 1 Corner U 2 Corners R Rectangle S Square Z Custom													
6	DIRECT OUTPUT	09 900 lm/ft 08 800 lm/ft 07 700 lm/ft 06 600 lm/ft 05 500 lm/ft 04 400 lm/ft													
7	DIRECT OPTIC	P Opal Flush (Roll Optics) L Luminance Reducing ¹ A Asymmetric (Roll Optics) N None													
8	CRI	9 90 CRI													
9	CCT	30 3000 K 35 3500 K 40 4000 K 00 Tunable White 2700–6500 K ² ZS Zumtobel SPECTRUM ²													
10	DRIVER	U 0-10 V, 1%, 120 V / 277 V D DALI, 1%, 120 V / 277 V H Lutron EcoSystem, 1%, 120 V / 277 V C 0-10 V, 1%, 347 V T Tunable White DALI Signal													
11	FINISH	W White S Silver B Black													
12	CONTROL OPTIONS	N None E Enlighted ³ W Wireless ³													
13	ACCESSORIES *	C EM Circuit ⁴ B EM Battery ⁵ P Chicago Plenum N Chicago Plenum and EM Circuit ⁴ E Chicago Plenum and EM Battery ⁵													
14	EM START	1 Start EM 0 None													
15	EM MID	X Quantity from 1 to 9 0 None													
16	EM END	1 End EM 0 None													

* COMPLETE 13-14 IF EMERGENCY OPTIONS ARE REQUIRED.

1 Luminance Reducing Optic is only available in 600 lm/ft, 500 lm/ft and 400 lm/ft packages. Asymmetric Optics only available with 400 lm/ft, 500 lm/ft and 600 lm/ft packages.

2 Must consult factory for Tunable White or Zumtobel SPECTRUM configurations, and are not available with Asymmetric Optics. Must be ordered with **T** driver option.

3 Only available with 0-10 V dimming. Enlighted Control not available with damp rating.

4 Add EM circuit option when designating only a portion of a continuous run is to be circuited for emergency. If an entire fixture or entire run is EM then this option is provided as standard.

5 EM battery available in 4' or greater sections. EM battery is not available with 347 V driver option.

We reserve the right to change, without notice, specifications or materials. Supporting documentation found on zumtobel.us are the most recent versions and supersede all other versions that exist in any other printed or electronic form.

Zumtobel Lighting, Inc. ©2023

3300 Route 9W, Highland NY 12528-2630

845-691-6262 | 800-448-4131

info.us@zumtobelgroup.com

061323_F

IBEW UNION MADE

Component Order Codes

The lens is a polycarbonate , field cuttable, roll lens shipped in various length rolls.

4" Width			
25' Roll Optic Opal Flush	M0048103-25	25' Roll Optic Luminance Reducing	05600204
50' Roll Optic Opal Flush	M0048103-50	25' Roll Optic Asymmetric	05600210
100' Roll Optic Opal Flush	M0048103-100	50' Roll Optic Luminance Reducing	05600205
150' Roll Optic Opal Flush	M0048103-150	50' Roll Optic Asymmetric	05600211
Lens Removal and Cutting Kit	11055253		
Lens Joiner Kit, White	11055256		
Lens Joiner Kit, Black	11055423		
Lens Joiner Kit, Titan	11055427		

Optical Performance

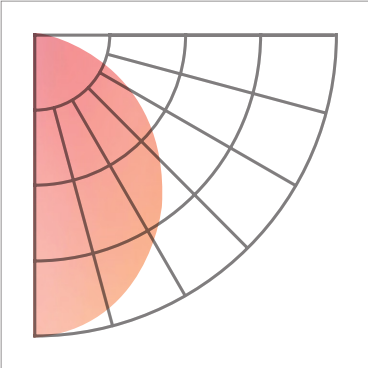

OPAL OPTIC | 800 LM/FT | 935

Average Luminance cd/m²

Vertical Angle	Horizontal Angle 0°
0	10520
45	9270
55	8747
65	8049
75	6659
85	3730



ASYMMETRIC OPTIC | 600 LM/FT | 935

Average Luminance cd/m²

Vertical Angle	Horizontal Angle 0°
0	9957
45	15870
55	12630
65	8994
75	6632
85	4148

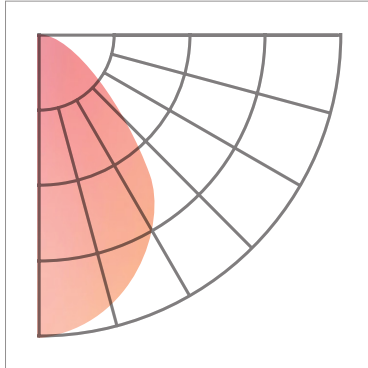

LRO OPTIC | 600 LM/FT | 935

Average Luminance cd/m²

Vertical Angle	Horizontal Angle 0°
0	11460
45	6716
55	4875
65	2962
75	2431
85	1211

Lumens*

		DIRECT														
		Opal						LRO			Asymmetric					
		400	500	600	700	800	900	400	500	600	400	500	600	700	800	900
3000 K	LM/W	87	86	85	84	83	81	72	71	70	100	98	97	96	95	94
	W/ft	4.6	5.8	7.1	8.1	9.7	11.1	5.5	7.0	8.6	4.0	5.1	6.2	7.3	8.4	9.6
3500 K	LM/W	90	88	87	86	85	84	74	73	72	102	101	100	98	100	99
	W/ft	4.5	5.7	6.9	8.1	9.4	10.8	5.4	6.8	8.3	3.9	5.0	6.0	7.1	8.0	9.1
4000 K	LM/W	91	89	88	87	86	85	75	74	73	103	102	102	101	101	100
	W/ft	4.4	5.6	6.8	8.1	9.3	10.6	5.3	6.8	8.3	3.9	4.9	5.9	6.9	8.0	9.0

* Exact programming levels available as a modification.

Dimensions

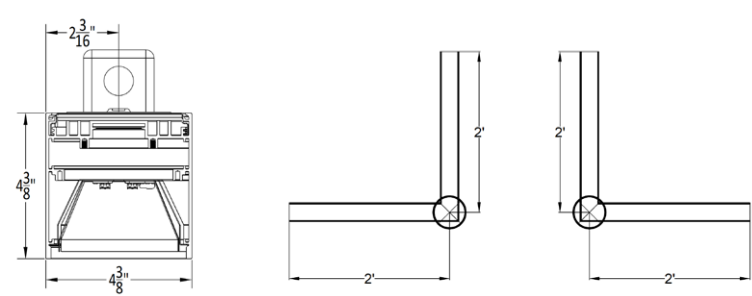

Technical Detail

1) Construction: The Luminaire consists of a painted aluminum housing and a choice of opal/clear polycarbonate roll optics with integrated continuous feed wiring.

2) Wattage & CCT: Fixture is available in lumen packages of 900 lm/ft, 800 lm/ft, 700 lm/ft, 600 lm/ft, 500 lm/ft and 400 lm/ft. Wattage is determined by lumen package and CCT chosen. Available in 3000 K, 3500 K or 4000 K color temperatures with 90+ CRI. 3-Step MacAdam Ellipse.

3) Driver: The unit is available with standard 120 V / 277 V 0-10 V dimming driver (1%), 347 V 0-10 V dimming driver (1%), Lutron LDE1 Hi-lume 1% digital EcoSystem with SoftOn/ FadeToBlack, or DALI dimming driver (1%). For non-dimming applications a 0-10 V driver will be provided, cap off the two control wires and connect the hot/neutral and ground as normal. Wireless dimming is only available with all 0-10 V driver options.

Tunable White fixtures have the option of DALI controlled dimming signal or Osram Dexal. If Osram Dexal is a requirement compatible control interfaces must be purchased directly from Osram. DALI dimming option uses protocol 8. Wireless dimming is available through eldoLED BLE radio and controlled by 4remote BT app or Bluetooth switches.

4) Zumtobel SPECTRUM: Please use QR code for complete details.



5) Optic/Lens: The unit is available with an Opal Flush optic obtained from a polycarbonate roll optic that is available in 25', 50', 100' and 150' continuous rolls for seamless run effect. A joining kit with cover plate will be required every 150' for longer run lengths. Field cutting instructions are provided with the standard installation guide. A lens cutting tool kit is available to order as a separate accessory. Roll lens for LRO and asymmetric fixtures are available in 25' rolls, a joining kit with cover plate will be required every 25' for longer run lengths. If UGR <19 is a project requirement please order fixture with LRO roll optic.

Asymmetric optic can be provided in either direction perpendicular to the length and will be designated 'right' or 'left' based on power feed in. The factory will consult client for desired asymmetric optic direction.

6) Mounting: Concealed mounting locations provided 6" or 18" from ends of fixtures. Consult installs for complete details.

7) Length: Individual fixtures and straight runs lengths can be ordered in exact length increments of 1/8" with a 2' minimum. Lengths of 8' and under are provided as individual fixtures. Lengths greater than 8' are provided as runs comprising of start, middle and end sections.

Configurations total length should be measured from the outside perimeter of the configuration to the nearest foot. Shop drawings with the exact configuration measurements will be provided with all configuration orders for approval.

Individual units have pre-installed roll optic within the fixture, for runs and configurations the roll optic will be provided in a separate roll to be field installed and will appear as an additional line item on shipping documentation.

8) Controls: Fixtures can be purchased with Enlighted ready controls and daylight saving/ occupancy sensor, this option requires an Enlighted compatible control interface provided by others to function. All orders with a sensor chosen will be provided with drawings showing the exact sensor placement.

9) Emergency Options: Fixtures can be either purchased for emergency circuit or emergency battery operation. EM Battery fixtures are available in 8' sections and can be ordered as start, middle or end fixtures. The factory will consult with the client for EM placement on configurations. Average Lumen output for EM Battery is 600 Lumens.

10) Life: 50,000 hours, L85.

11) Weight: 4.45 lbs per 2ft.

12) Declare Information:

